

VANGUARD MODELS

BY CHRIS WATTON

****34ft Launch****

Recommended tools:

1. Sharp knife such as a scalpel, X-acto or Stanley.
2. Sanding sticks or abrasive papers (110 – 320 grade)
3. Steel rule
4. Needle/jeweller's files
5. Small clamps
6. Small tweezers
7. Masking tape (Tesa, Tamiya etc.)
8. Fine paintbrushes
9. Titebond I/II wood glue
10. Gorilla Glue CA gel

Recommended Paints etc.

1. Plastikote matt white spray
2. Plastikote matt black spray
3. Vallejo black and brown acrylics
4. Mr Metal Colour aluminium paint
5. Ronseal Matt Polyurethane varnish

1.

Remove all parts from the 2mm MDF sheet and sit each bulkhead into its corresponding position on the base. Do NOT glue.

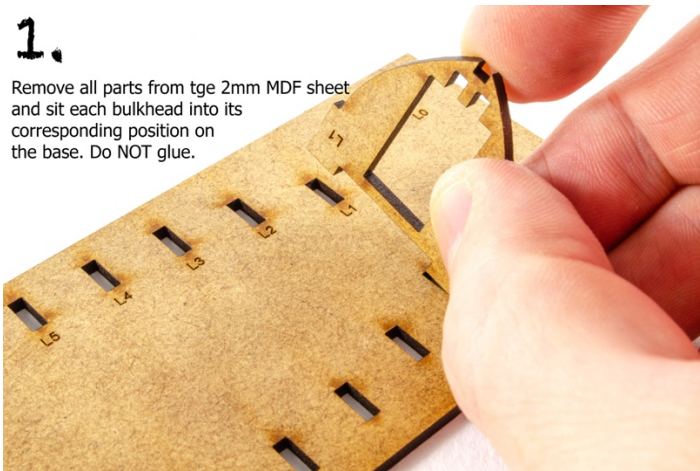

2.

With all bulkheads in position on the base, remove the keel, L14, from the 2mm pear wood sheet

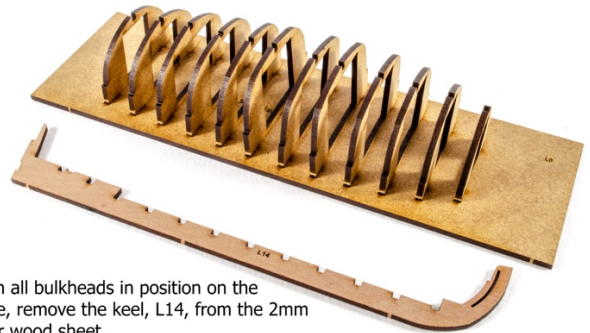

3.

Sit the 2mm pear wood keel into the slots on each bulkhead. You may need to joggle things about to get it to sit. Once in position, brush wood glue into each joint and allow to thoroughly dry.



4.

Remove the stern board, L13 from the 1mm pear wood sheet and glue it into position on the keel as shown here. Allow to thoroughly dry.

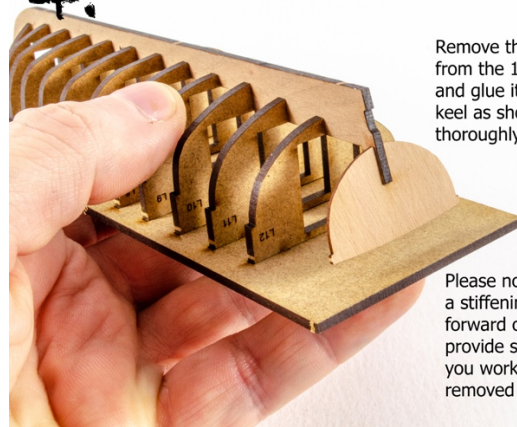

Please note that we have added a stiffening piece to the keel, just forward of this point. This is to provide strength to your hull as you work on it, and it will be removed later in construction.

5.

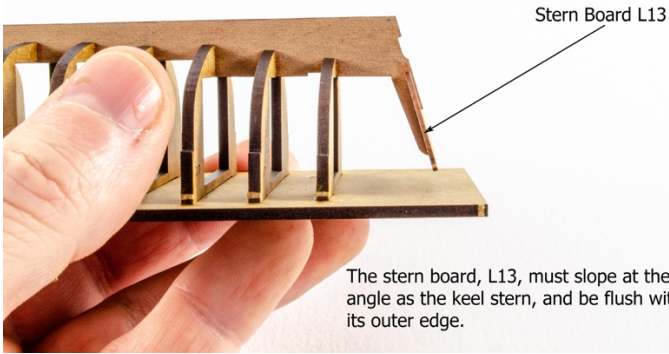

The stern board, L13, must slope at the same angle as the keel stern, and be flush with its outer edge.

6.



Cut the two bow planking patterns, L15, from the 2mm MDF sheet and bevel the forward edges on one side, as seen in this photo.

7.

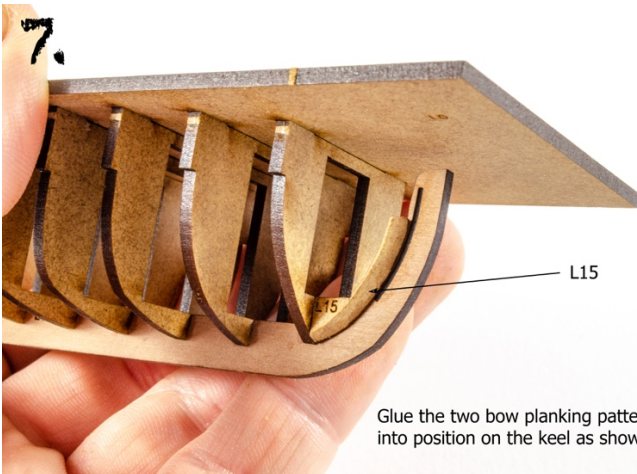

Glue the two bow planking patterns, L15, into position on the keel as shown here.

8.

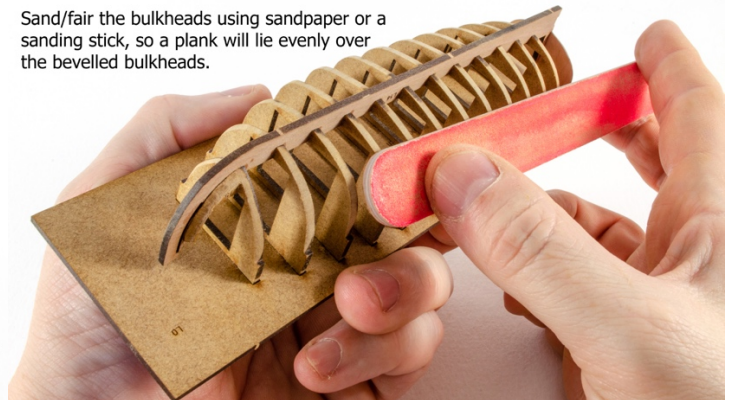

Sand/fair the bulkheads using sandpaper or a sanding stick, so a plank will lie evenly over the bevelled bulkheads.

9.



If you decide to soak the first planks to bend them, make sure you allow to thoroughly dry before fitting them.

10.

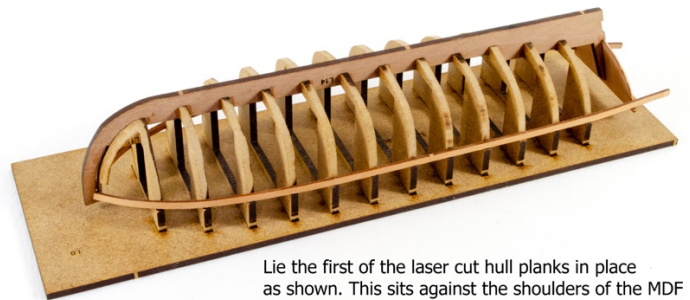

Lie the first of the laser cut hull planks in place as shown. This sits against the shoulders of the MDF bulkheads. We advise using wood glue for this, and not CA.

11.

Note that the plank sits on the bulkheads with as much surface contact as possible due to previously bevelling the bulkheads

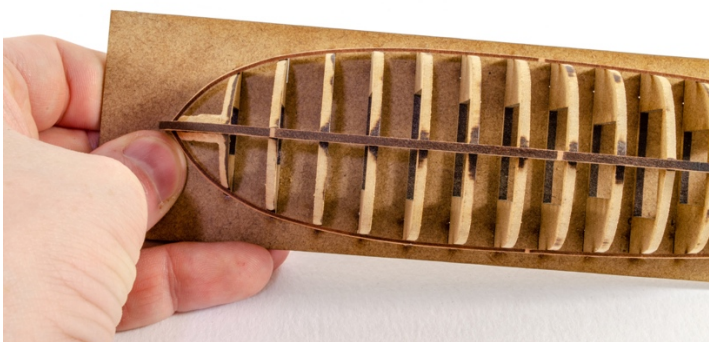

12.



Using more 0.6mm planks (L29), continue to plank upwards towards the keel. To get maximum contact to the bulkheads, you will need to taper the planks. The pencil marks seen here are where these were tapered from. Edge-bevelling the planks will allow them to sit snugly together too. You will probably find it necessary to start planking from the keel at some point, and meet up with the previous planking.

13.



Here you can see the completed planking. It's perfectly ok to use infill planks (stealers) to close up any gaps, as these won't be seen underneath the paint layer. You can see these infill planks in this photograph.

14.

Sand the hull smooth using 110 grade abrasive paper to start with, and then finishing with finer grades. We suggest any imperfections are filled with an acrylic filler, diluted with water.



15.



Your sanded hull should look like this. Trim down the planks at the stern and sand them flush with the stern board.

16.

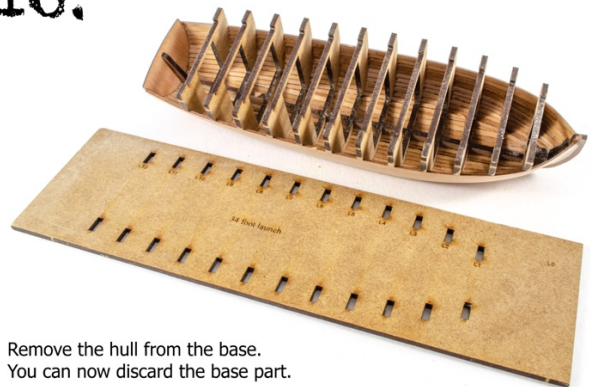

Remove the hull from the base. You can now discard the base part.

17.

Use cutters to snip out the bridge on each of the MDF bulkheads.



18.

Use pliers to carefully remove each side of the MDF bulkhead. Gently twisting from side to side is the best method. The base of the bulkhead will remain in place on the keel.



19.



Use the narrower laser-cut planks to add the ribbing inside the hull as shown. Place these so there is a space of 5mm to 6mm between ribs.

20.



Now fit the medium width laser-cut planks into position as shown here, forming the seat support rails. To do this, add a pencil mark 6mm down from the top of the bulwark, onto each rib, and glue the strip underneath those marks. Note that the rear ribs are cut down in height to accommodate seating L27.

21.



OPTIONAL: To create a wood finish to the PE floor sections, you can first apply a coat of Tamiya XF-59 Desert Yellow.



On top of the paint, you can now apply a very thin coat of Raw Sienna oil paint, using a piece of foam.



Spots of Raw Umber oil paint can now be randomly applied to the previous oil paint covering.



Using your foam sponge, drag the dark oil paint spots into the lighter layer below. Keep doing this until you achieve the desired result.

You can make your wood effect as subtle or coarse as you wish.



A fan brush could also be used to create knot effects and a more natural flow to the grain.



22.

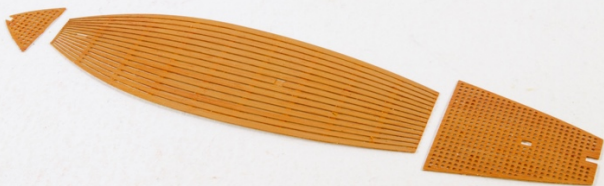

Once you have painted your photo-etch floor sections, set them aside and allow to thoroughly dry. If you used the oil paint technique, you should leave the parts between 24 and 48hrs.

23.



Use CA to glue each of the floor sections into place as shown.

24.

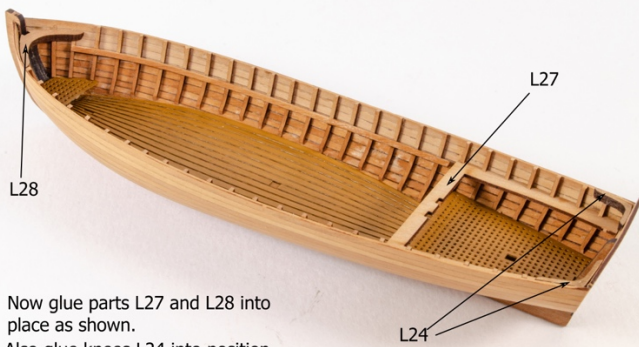

Now glue parts L27 and L28 into place as shown.
Also glue knees L24 into position.

25.

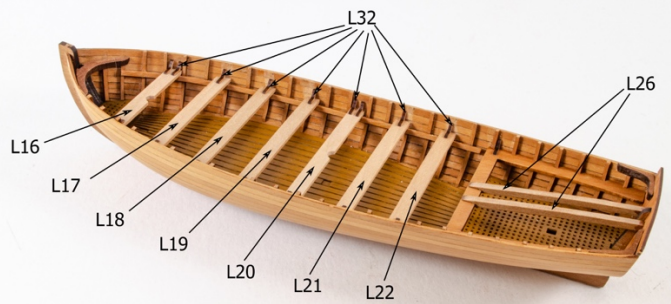

Glue the seating parts L16 thru to L22 into place and also the knees, L32, as shown. Glue parts L26 into position.

26.

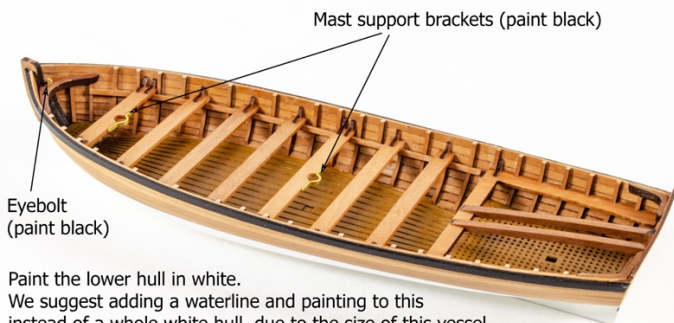

Paint the lower hull in white.
We suggest adding a waterline and painting to this instead of a whole white hull, due to the size of this vessel.
Paint two planking strips black and glue them flush with the top of the bulwark. Use CA to glue the mast support brackets and eyebolt from the PE sheet. You will need to bend the brackets as seen here.

27.

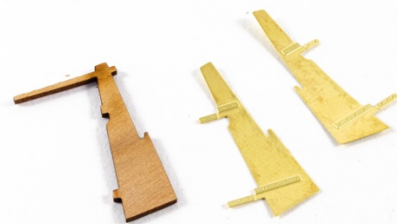

Cut the rudder, L23, from the 1mm pear wood sheet and also the facing parts from the photo-etch sheet.

28.



Use CA gel to glue the PE parts to the rudder. Paint the rudder white and then remove the tiller arm.

29.

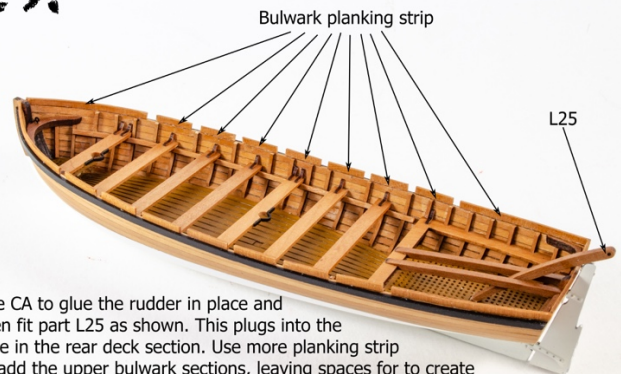

Use CA to glue the rudder in place and then fit part L25 as shown. This plugs into the hole in the rear deck section. Use more planking strip to add the upper bulwark sections, leaving spaces for to create the rowlocks.

30.



Use CA to glue the anchor together and then paint black.

31.



You are given the choice of using either photo-etch or wooden oars. If you use the wooden ones, sand the paddle to shape and slightly round the handle. To paint, we chose white for the handle with a varnished paddle. The paddle tip is painted in copper.

32.



Glue the oars into position as shown. Fit the two anchors and also the boat hooks. The hooks need to have a wooden handle and a metal tip.

