



## Mini Slash® 4x4 Number Plate Installation

Covers Part #10813

### Kit contents:

- Number plates (2)
- Decal sheet
- 2x5mm button-head cap screws (BCS) (4)
- M2 nylon locknuts (4)

### Tools needed:

- 2.0mm hex wrench
- 1.5mm hex wrench
- 4mm wrench
- Tapered body reamer (part #3433 or #3433X, sold separately)
- Fine tip marker



### CAUTION: RISK OF INJURY!

Use care with hobby knives, tapered reamers, and other cutting tools as they are extremely sharp and can cause severe injury, deep cuts, and/or punctures.

- 1** Remove the body from the chassis. Remove the 3x8mm BCS (6) from the side skirts to remove from the truck body.

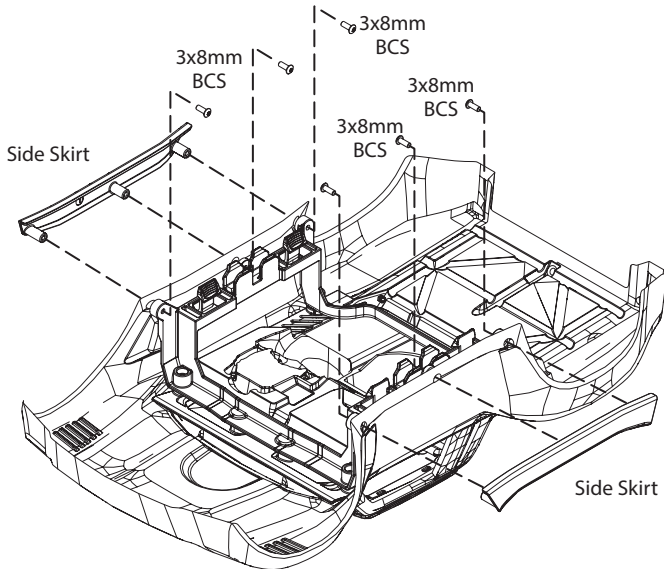

- 2** Remove the 3x8mm BCS from the body cage (4) and interior (2) to remove these parts from the truck body.

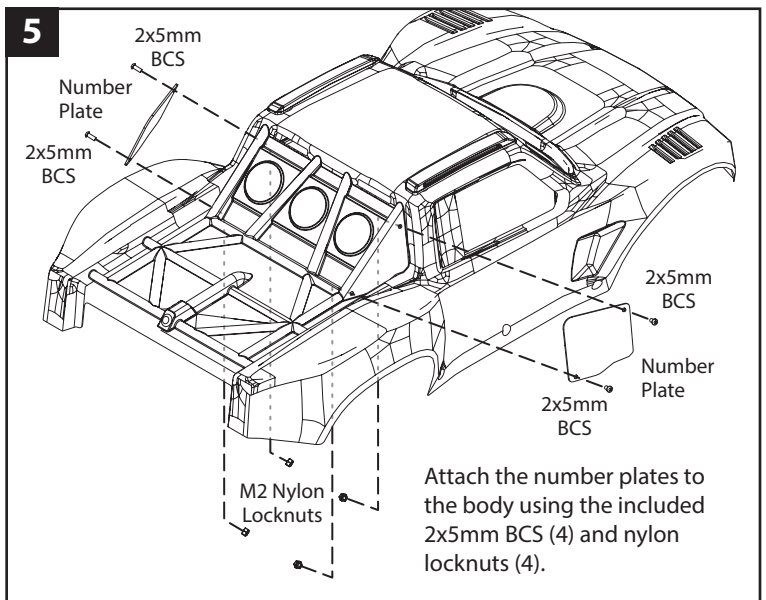
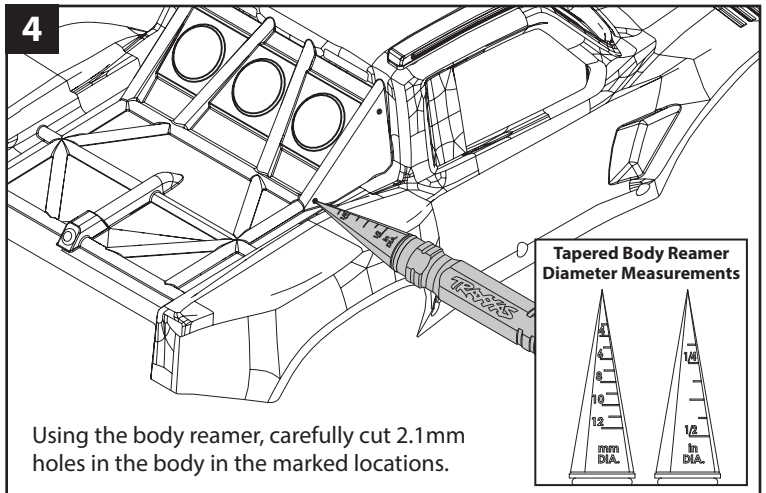
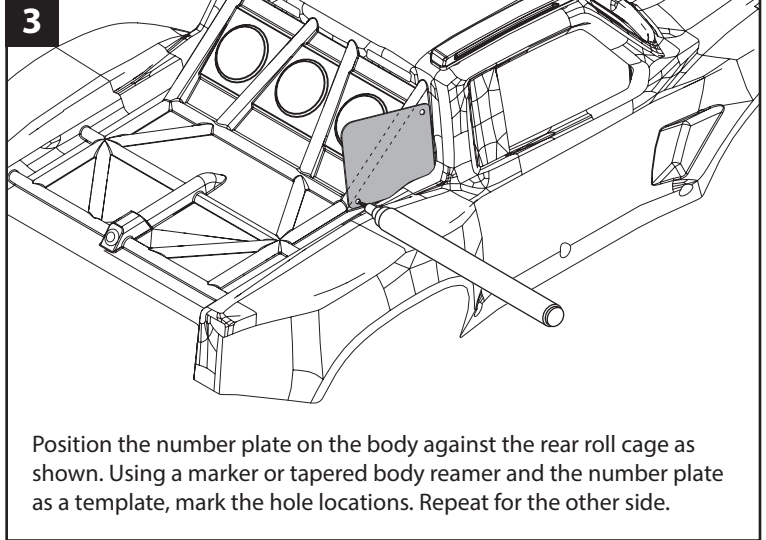
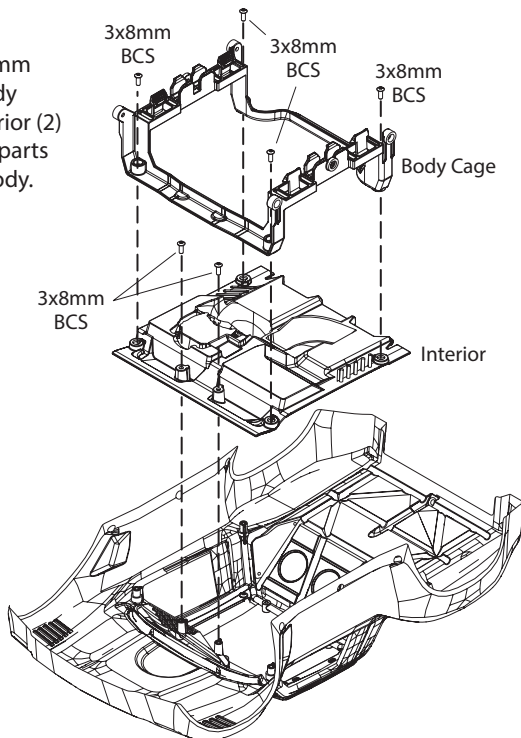

- 6** Reinstall the side skirts, body cage, and interior using the screws removed in the previous steps. Apply numbers from included decal sheet to number plates.