

SCX10 III Portal

1. Remove the existing kingpin shoulder screw and replace it with the supplied shoulder screw stud. Install the mounting bracket as shown.
2. Secure the magnet mount to the bracket using the provided M2.5x4 socket head cap screws (SHCS), as shown.
3. Adjust the magnet position as needed using the slotted adjustment range and/or by carefully bending the steel mounting bracket.

Note: Magnets should be positioned close to the tire, but must not contact the tire.

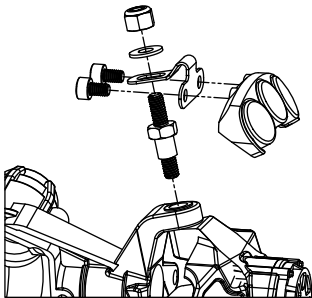

SCX10 III Straight Axle

1. Attach the magnet mounting bracket to the knuckle using the provided shoulder screw, as shown.
2. Secure the magnet mount to the bracket using the supplied M2.5x4 socket head cap screws (SHCS), as shown.
3. Carefully bend the bracket ears as needed so the bracket rotates with the knuckle without any free play or backlash.
4. Fine-tune the magnet position by gently bending the steel mounting bracket.

Note: Magnets should be positioned close to the tire, but must not contact the tire.

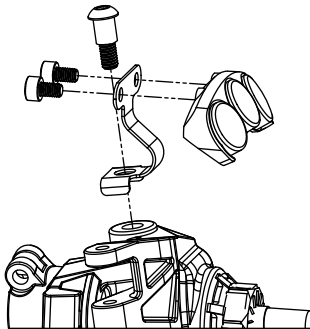

TRX-4

1. Remove the existing kingpin screw and replace it with the provided M3x20 set screw.
2. Install the magnet mounting bracket onto the set screw, as shown. Tighten the nuts firmly against each other to lock them in place, but only lightly against the axle housing.
3. Attach the magnet mount to the bracket using the provided M2.5x4 socket head cap screws (SHCS), as shown.
4. Adjust the magnet position as needed using the slotted adjustment range and/or by carefully bending the steel mounting bracket.

Note: Magnets should be positioned close to the tire, but must not contact the tire.

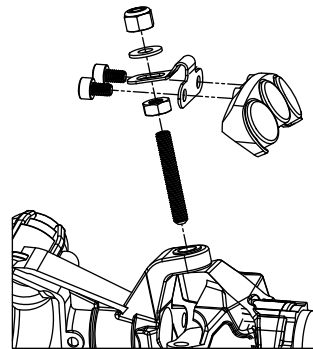

PR0647990