

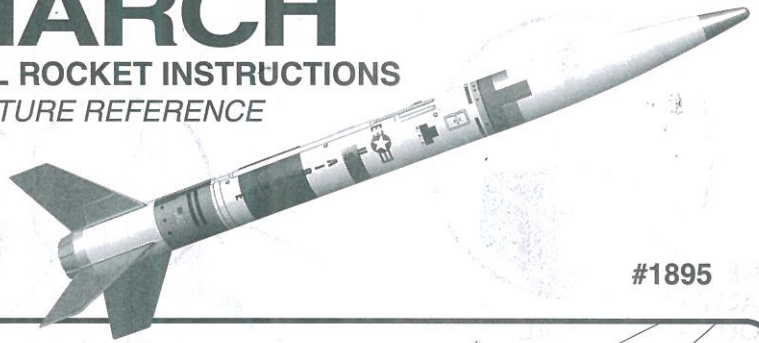

www.estesrockets.com
 ESTES-COX CORP.
 1295 H Street
 Penrose, CO 81240
 PRINTED IN CHINA

PATRIARCH™

READY TO FLY MODEL ROCKET INSTRUCTIONS
 KEEP FOR FUTURE REFERENCE



#1895

ASSEMBLY TIP: Read all instructions before beginning work on your model. Make sure you have all parts and supplies.

1. PARACHUTE ATTACHMENT

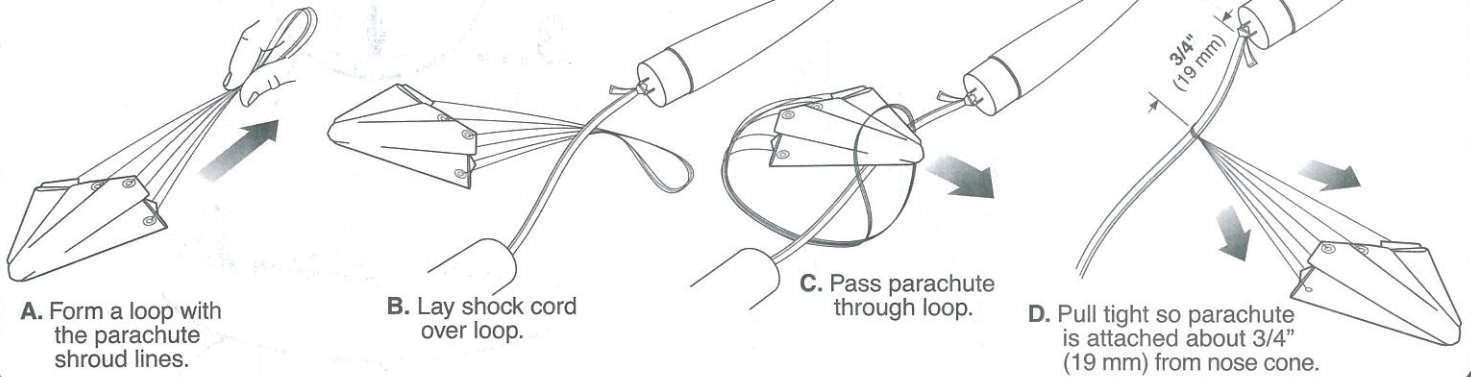

2. PREPARE PARACHUTE FOR FLIGHT

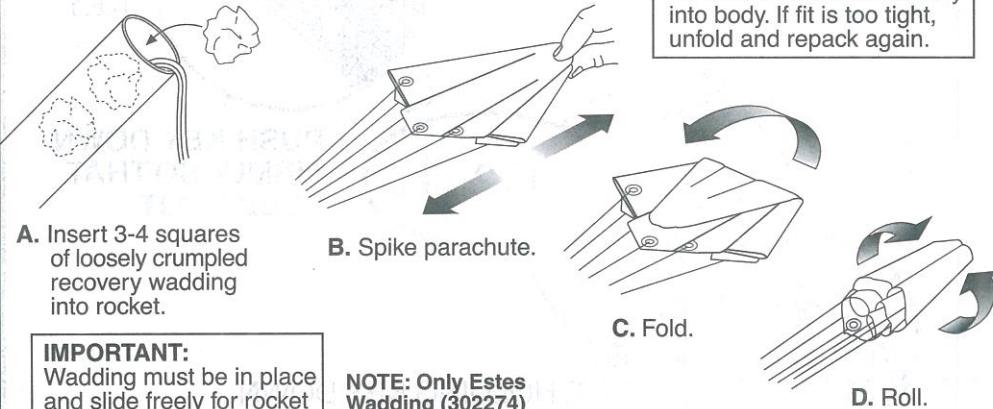

IMPORTANT: Parachute should slide easily into body. If fit is too tight, unfold and repack again.

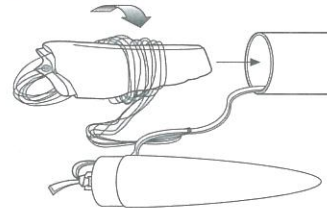

E. Wrap lines loosely. Insert chute, shock cord and nose cone into body tube.

HELPFUL HINT: IF NOSE CONE FIT IS...

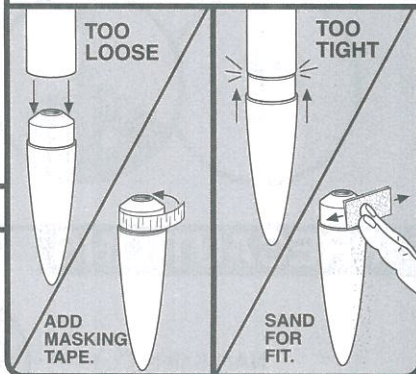

3. PREPARE ENGINE

WARNING: FLAMMABLE
 To avoid serious injury, read instructions & NAR Safety Code included with engines before proceeding. **PREPARE YOUR ENGINE ONLY WHEN YOU ARE OUTSIDE AT THE LAUNCH SITE PREPARING TO LAUNCH!** If you do not use your prepared engine, remove the igniter before storing your engine.

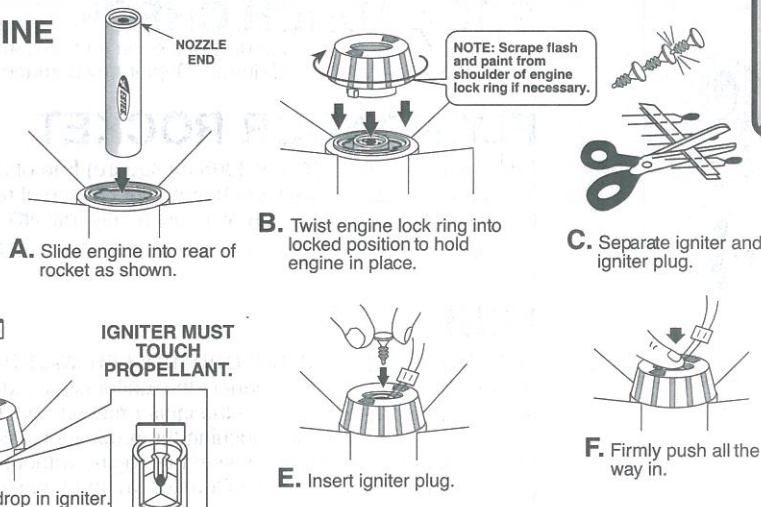

IGNITER MUST TOUCH PROPELLANT.

NOTE: Scrape flash and paint from shoulder of engine lock ring if necessary.

COUNTDOWN AND LAUNCH

ESTES LAUNCH SUPPLIES

(Sold Separately)

- Porta Pad® II Launch Pad
- Electron Beam® Launch Controller
- Recovery Wadding (included with some engines)
- Igniters (with engines)
- Igniter Plugs (with engines)
- Recommended Engines: A8-3, B4-4, B6-4, C6-5

KEY ALWAYS OUT UNTIL FINAL COUNTDOWN!



1...



MASKING TAPE

2...

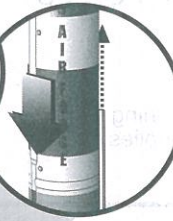

3...

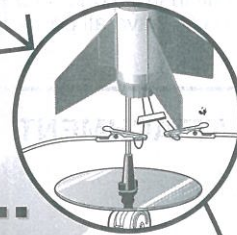

4...



INSERT KEY

5...

4... 3... 2... 1...

PUSH KEY DOWN FIRMLY SO THAT BLUB IS LIT.

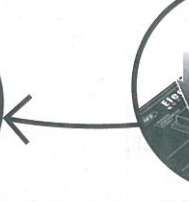
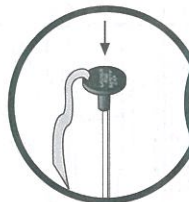

WHILE HOLDING KEY DOWN, PRESS LAUNCH BUTTON UNTIL LIFTOFF!

PRECAUTIONS

NAR Safety Code



NO DRY GRASS OR WEEDS

PRE-LAUNCH CHECK

For safety, never launch a damaged rocket. Check the rocket's body, nose cone and fins. Also, check the engine mount, recovery system and launch lug(s). Repair any damage before launching the rocket.

FLYING YOUR ROCKET

Choose a large field (1000 ft. [305 m] square) free of dry weeds and brown grass. The larger the launch area, the better your chance of recovering your rocket. Football fields and playgrounds are great. Launch only with little or no wind and good visibility. Always follow the National Association of Rocketry (NAR) SAFETY CODE (Copy enclosed).

MISFIRES

TAKE THE KEY OUT OF THE CONTROLLER. WAIT ONE MINUTE BEFORE GOING NEAR THE ROCKET! Disconnect the igniter clips and remove engine. Take the plug and igniter out of the engine. If the igniter has burned, it worked but did not ignite the engine because it was not touching the propellant inside the engine. Put a new igniter all the way inside the engine without bending it. Push the plug in place. Repeat the steps under Countdown and Launch.