

new



SUPER FLYING MODEL CO.

SKY BABY

• 25-L

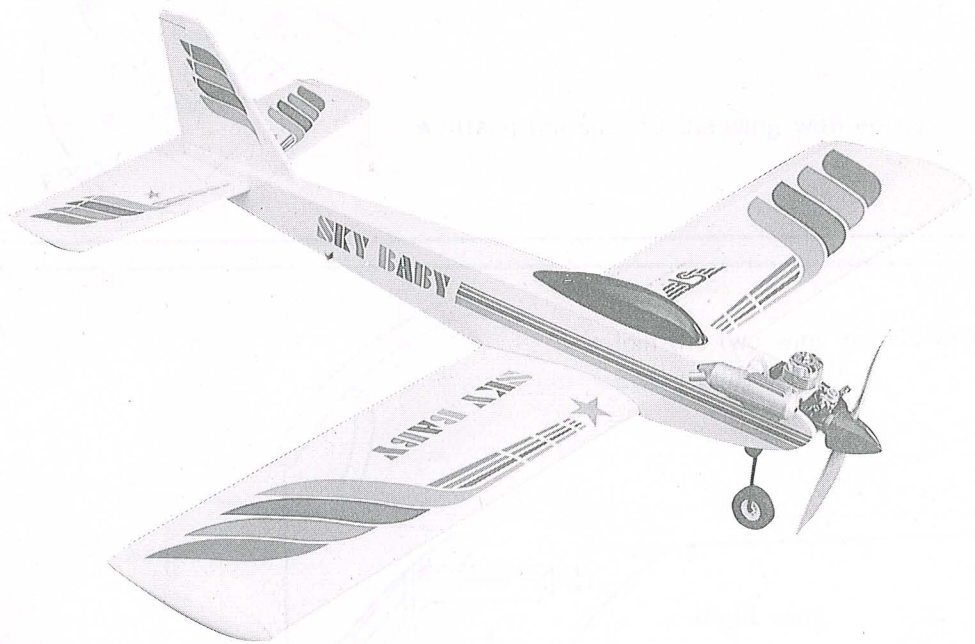

Wing Span (52 inches) 1320 mm
Length (36.81 inches) 935 mm
Wing Area (425.97 sq.in.) 27.5dm²
Weight (3.19 lbs-3.41 lbs) 1450~1550g
Engine 19-32
Radio 3-4 channel

1

Make the hinges soft first

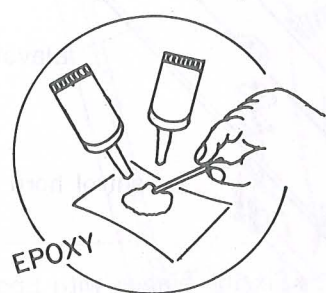
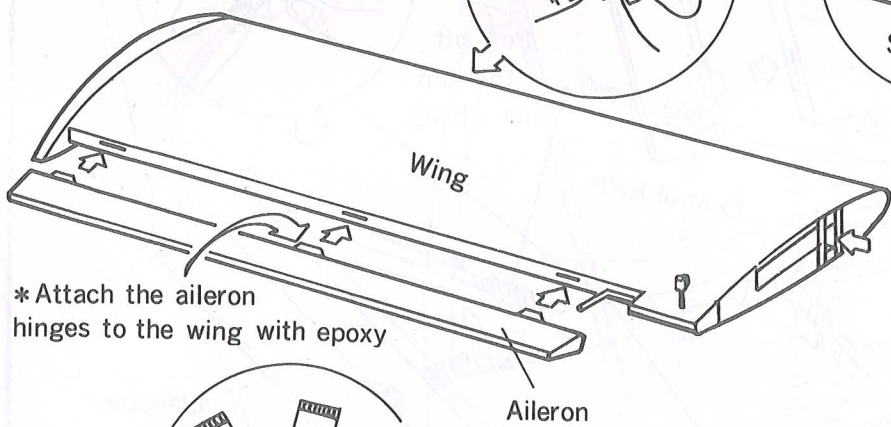
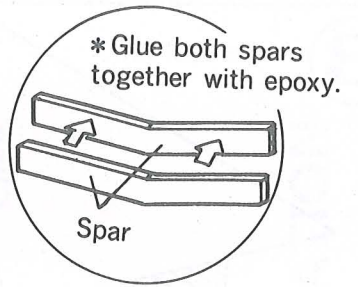
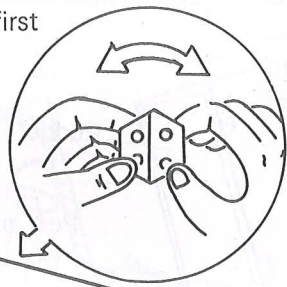

* Attach the spar to the wing with epoxy.

2

* Join the two wing panels with Epoxy adhesive.

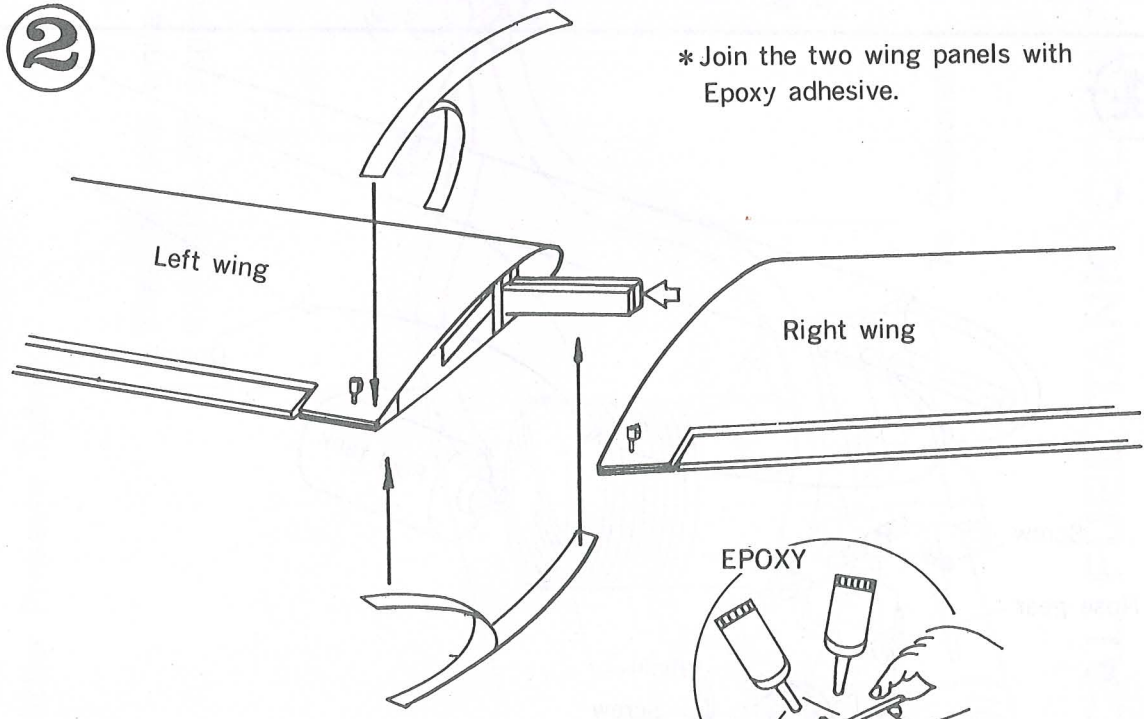

* Apply the tape on joint of wing.

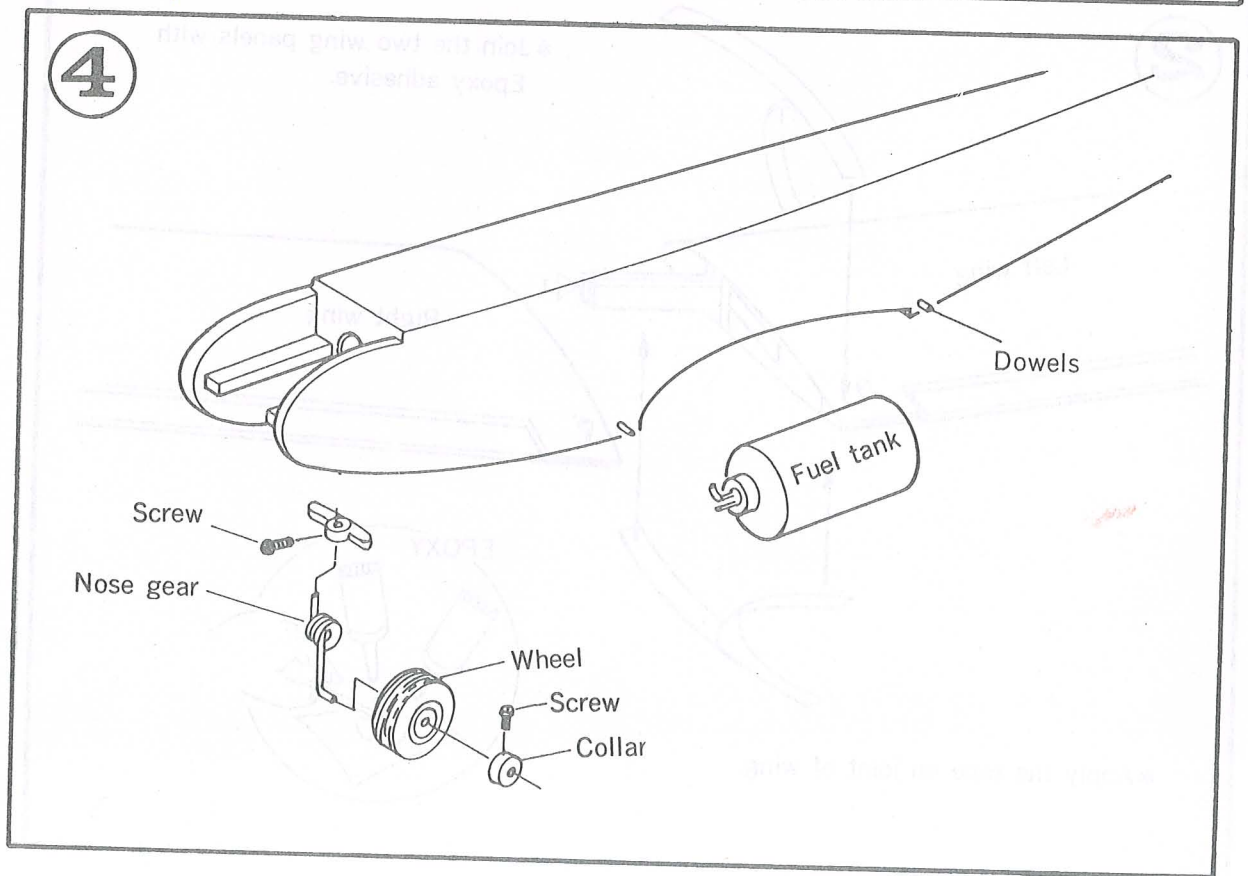
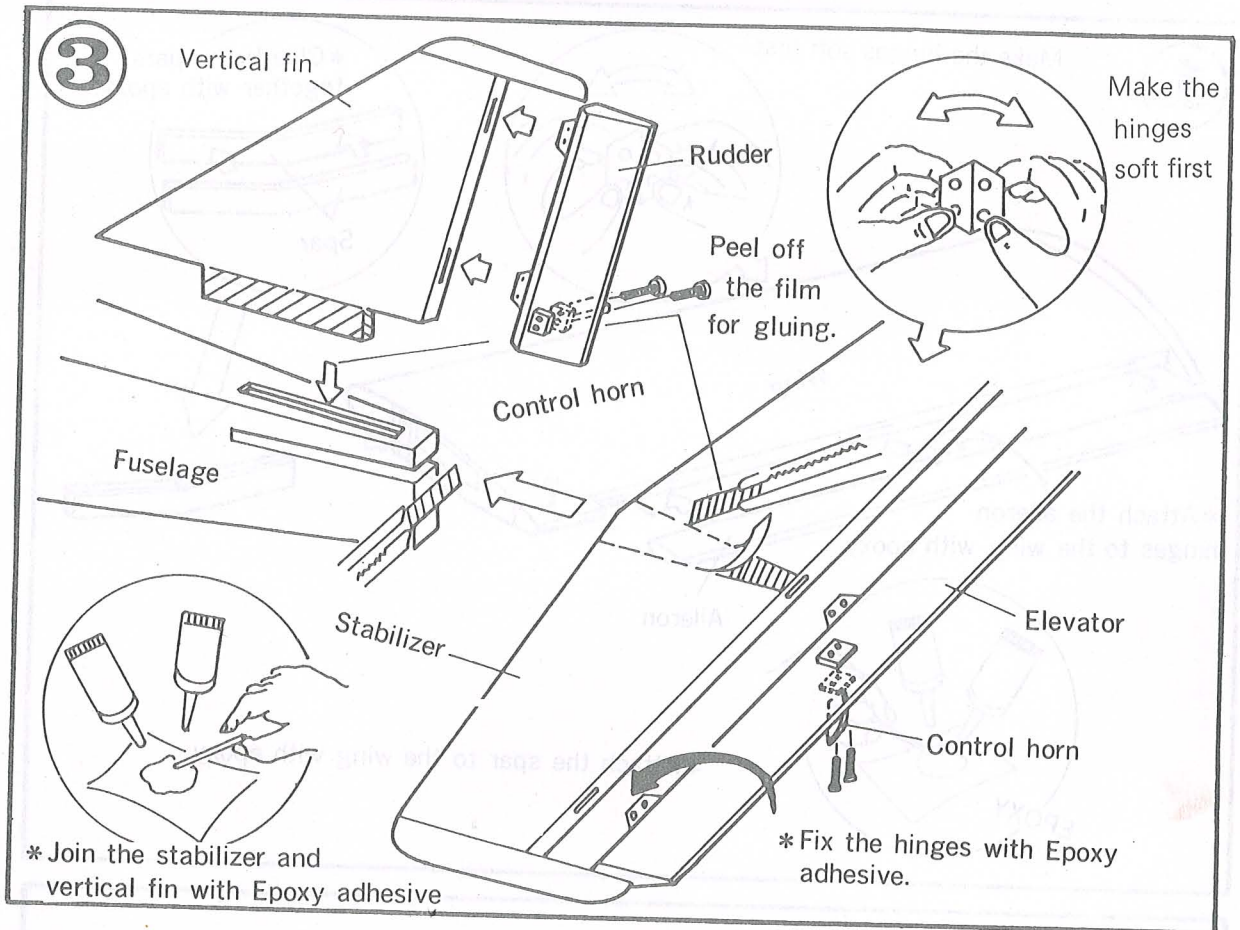

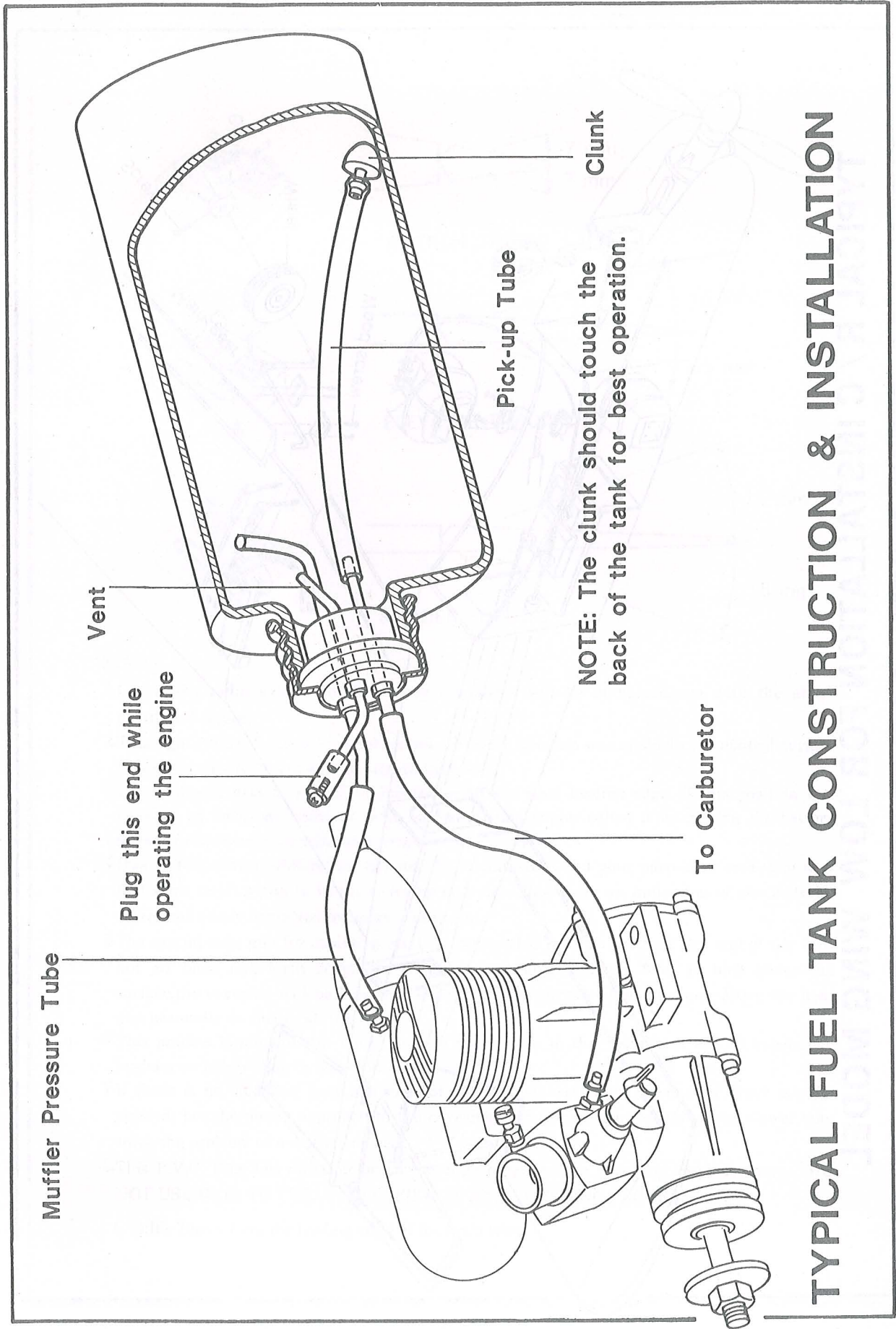

Muffler Pressure Tube

Plug this end while operating the engine

Vent

Pick-up Tube

Clunk

NOTE: The clunk should touch the back of the tank for best operation.

To Carburetor

TYPICAL FUEL TANK CONSTRUCTION & INSTALLATION

TYPICAL R / C INSTALLATION FOR LOW WING MODEL

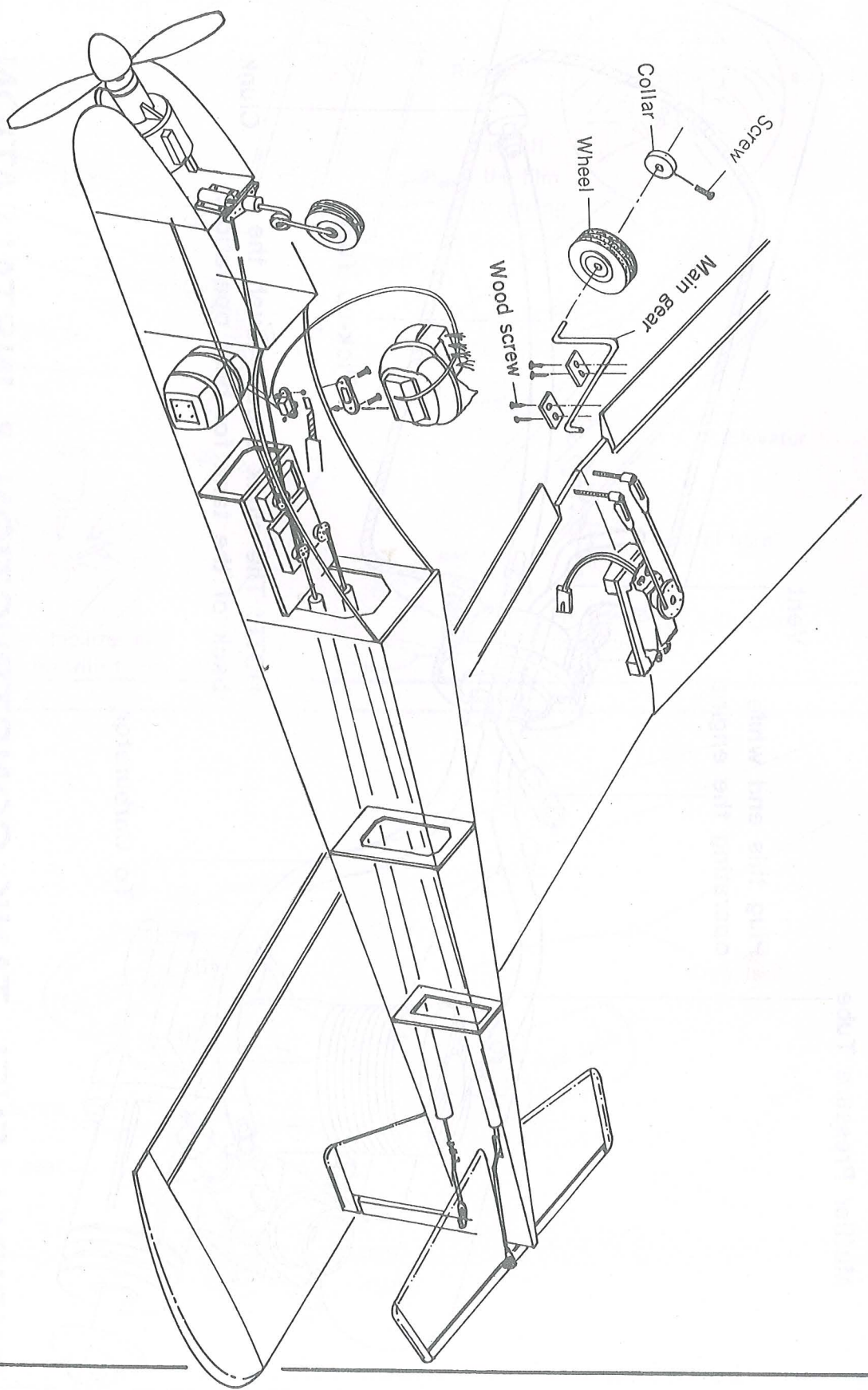

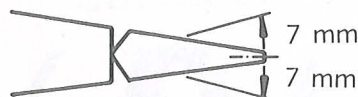
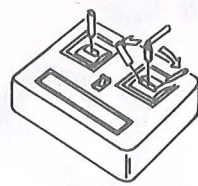

AILERON STROKE

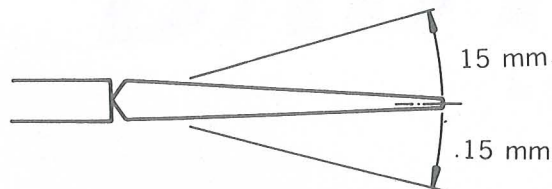
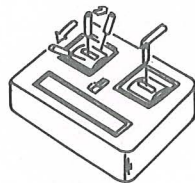

ELEVATOR THROWS

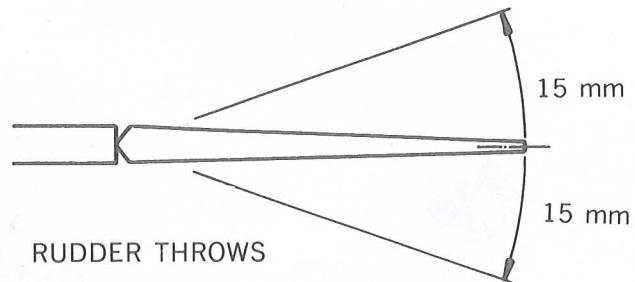
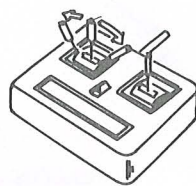

RUDDER THROWS

NOTE

1. Check the radio system so that every movement will be in accordance with the above mentioned figure.
2. This figure shows "Mode 1" function only. If other function was applied, the control surface movement should be the same as the figure indicated.
3. The center of gravity should be located at 70 mm from the leading edge. If this position was changed by different brand of radio equipment and engine, adjust it by moving the battery forward or backward, or add some weight at nose or tail.
4. Due to temperature difference between the manufacture and your particular area, you may find some small wrinkles in the covering material. This is not an indication of any material defect and easily corrected by using a heat gun.
5. The special heat gun for modeling use is recommended. Turn on the heat gun and gently flow hot air back and forth over the wrinkled area approximately 8 to 10 inches above the surface. The covering will be loosened at the beginning then shrunk after a moment. Move the heat gun gradually to shrink all the wrinkles.
6. This process is not difficult but, if you are not sure as to this technique, ask an experienced modeler or hobby shop to help you.
7. If there is no modeling heat gun, some of 800 to 1,000 watt high power hair dryer may be applied. Let the nozzle approach to the covering surface or move the hair dryer slower may solve the problem of insufficient heat.
8. This P.V.C. Film has different properties from other iron-on covering, so please note "DO NOT USE IRON TO TREAT P.V.C. FILM IN ANY COVERING PROCESS"

C.G: It's 70mm from the leading edge of the main wing.