

SKYRC[®] Micro Pneumatic Retract Landing-Gear Set

Specifications:

- *Low Profile 0.472"(12mm) when retracted
- *Frames 6061-T6 & 7075 aviation grade aluminium
- *Air used up, spring down
- *Each Retract Weight: 10 gram/All Parts 100 gram
- *Suitable for EDF & Warbirds Models up to 3.5lbs(1.59kg)

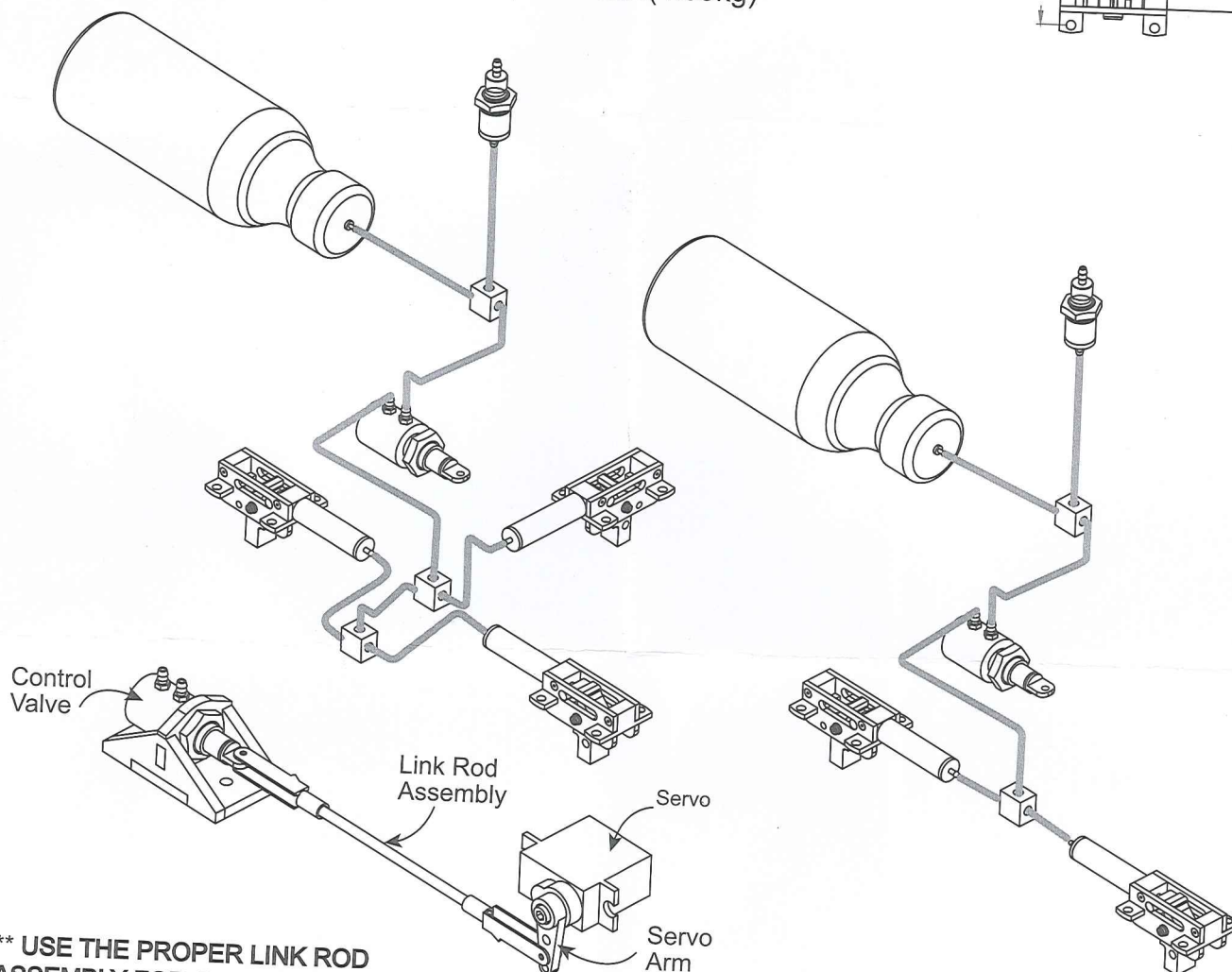
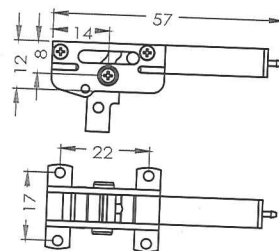

**** USE THE PROPER LINK ROD ASSEMBLY FOR CONTROL VALVE**

(mount, servo, servo arm, and link rod ass'y are NOT included in kit)

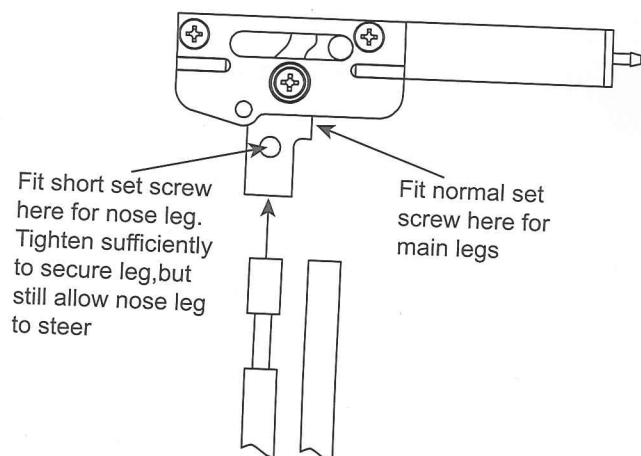

Micro Retracts		Trike Set	Mains Set
Description	Qty	Qty	
Main Gear	3	2	
Nose Leg	1	N/A	
Main Leg	2	2	
Steering Arm	1	N/A	
3-Way Connector	3	2	
Pressure Tubing (Yellow/2.5Mtr)	1	1	
Air Tank (65ml)	1	1	
Wood Screw (Gear Mount)	12	8	
Set Screw (M3)	3	2	
Set Screw (M2)	2	N/A	
Filler Valve	1	1	
Control Valve	1	1	
Spare O-Rings	1 Set	1 Set	
Steering Control Wire (500mm)	1	1	
Allen Key	2	1	