

RTR

BRUSHLESS MOTOR BOAT

ASSEMBLY AND OPERATION MANUAL

Specifications:

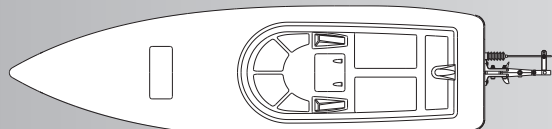

Model No: 8301 Bullet Deep Vee

Total Length.....729mm(28.7in)
Beam.....180mm(7.1in)
Speed.....45+KPH

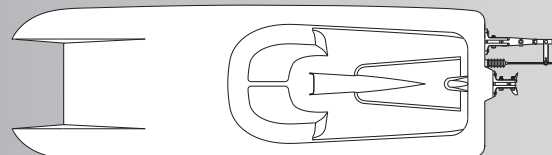

Model No: 8302 US . 1 Catamaran

Total Length.....678mm(26.7in)
Beam.....209mm(8.23in)
Speed.....45+KPH

Universal Assembly:

Motor.....Water cooled 2815 out-runer brushless motor(included)
Radio System.....2.4G 2CH Digital Proportional Transmitter(Included)
Speed Control.....Water cooling 60A Brushless ESC w/BEC (Included)
Drive System.....3mm Flex Cable Direct Drive
Battery.....11.1V 2200mAh 35C LiPo Pack(Not Included)

Caution for LiPo battery:

ESC with low voltage hard cut off at 3.2V per cell, when driving your boat , as soon as you notice boat stop, that means ESC low voltage cut off effective, you should immediately drive boat back to shore in slow speed , recharge battery and race again. don't keep racing boat when ESC low voltage cut off effective, otherwise, you will allow battery over discharge, battery voltage will reach very low and won't be recharged again.

IMPORTANT: THESE MODELS ARE CAPABLE OF OVER 45 KPH, PERSONAL INJURY OR PROPERTY DAMAGE MAY RESULT FROM MISUSE OF THESE PRODUCTS, TAKE CARE AND ENJOY OUR MODEL RESPONSIBLY.

Introduction

Thank you for purchasing Joysway brushless motor boat ! This manual contains the instructions you need to safely prepare, operate, and maintain your R/C boat. Read over this manual thoroughly before operating Joysway brushless motor boat.

Safety Precautions

- Operating care to avoid touching the propeller anytime the motor is operating. If your fingers, hands, etc. come in contact with the spinning propeller, you may be severely injured. This model is capable of inflicting property damage and severe personal injury if a collision occurs. Racing your boat responsibly, stay clear of people, full-scale boats and wildlife.
- The metal hardware on your boat can be sharp. Be careful handling the parts.
- The brushless motor may become hot. After a run allow the motor to cool before touching it.

Specifications & Description Changes

All pictures, descriptions, and specifications found in this instruction manual are subject to change without notice. Joysway maintains no responsibility for inadvertent errors in this manual.

Items Required For Completion & Battery Pack Recommendations

You will need to purchase the following items to operate your Joysway brushless motor boat. We highly recommend the use of the following products.

Battery Recommendation

One pack of 11.1V 2200mAh 35C LiPo Pack

NOTE: If you have existing 11.1V Lipo battery pack, you can update them for use by changing the connector to Deans connector which is included in the kits bag, be sure to solder the connector to the battery in the proper polarity. (1 Male Deans connector is already soldered with the ESC, the other 1 Female Deans connector is included in the kits bag)

Charger Recommendation

2S/3S Balance Charger and adapter, or multi-functional intelligent charger.

NOTE: You will also need 4 "AA" alkaline batteries for the transmitter.

Contents Of Set

- Water cooled 2815 out-runner brushless motor(included) (Pre-installed)
- 60A Water cooling Brushless ESC w/BEC(Pre-installed)
- Powerful Steering 37g Servo (Pre-installed)
- 2.4GHz 2CH Pistol Transmitter
- Display Boat Stand

kits bag contents:

1 Deans Plugs W/
1 Heat Shrinking Tube

2 pcs of Allen Key
(2.5mm,2mm)



Water proof
ballon for RX

Rubber Band

Hook & Loop Strap

Tow Pcs of P1.4XD40
Nylon Propeller

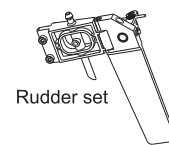

Rudder set

7mm & 5.5mm Spanner
(NOT INCLUDED)

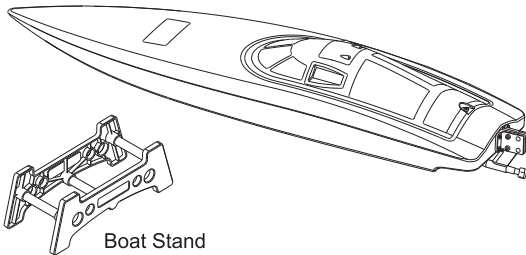

Boat Stand

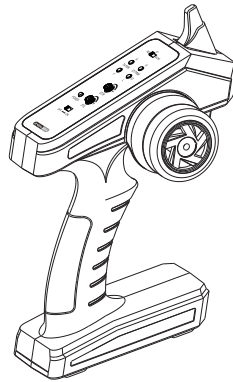

Circuit & Cooling System Diagram

CIRCUIT AND COOLING SYSTEM DIAGRAM IN THE BOAT

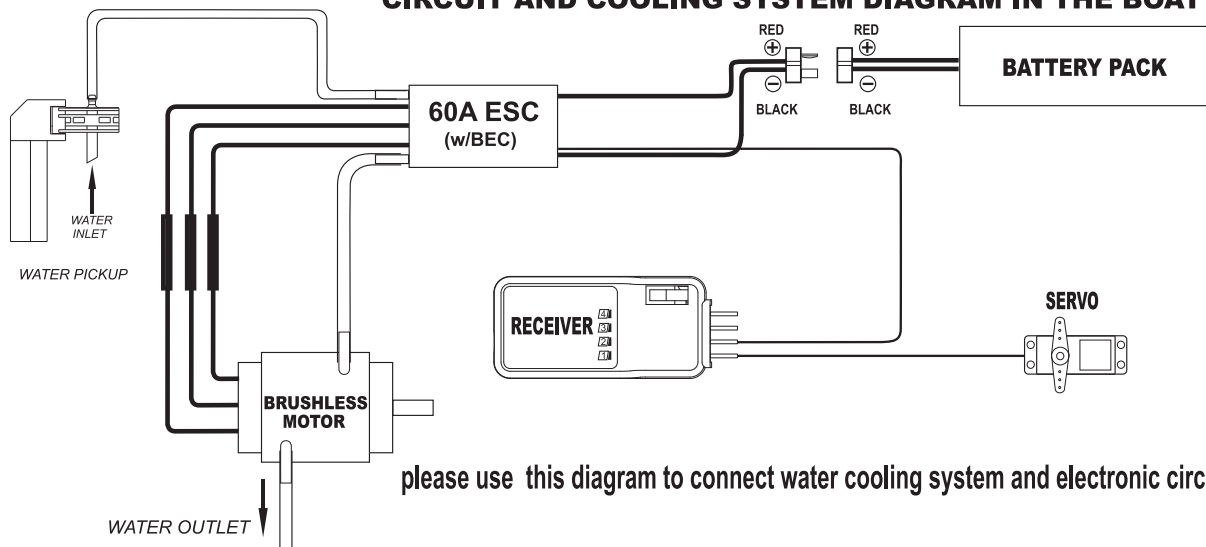

Preparing Your Boat For Operation

Assembling the boat stand

Insert three ABS pipes into the holes of two boat stands shown as photos, compress boat stands and ABS pipes tightly, then stick EVA to the four angles, this will protect the hull bottom from scratches during construction and storage.

NOTE: Bullet deep vee and US.1 catamaran boat use the same boat stand.

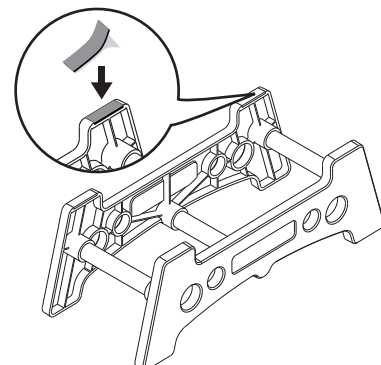

Installing the rudder and propeller

Concerning the package safety, the rudder and propeller are not pre-installed. They are packed well in the kits bag. Follow the belowing steps to install them by yourself easily

1. Loosen the screw on the propeller shaft by 7mm Spanner, put the propeller in then retighten the screw.
2. Insert the rudder support into the support which is already installed on the rear of hull. Thread the two pcs of M3 screw in, Apply two pcs of M3 nut on the screws, retighten the screws and nuts by 2.5mm Allen Key and 5.5mm Spanner.
3. Thread the silicone tube in the brass water inlet.
4. Loosen the adjuster on the servo horn so as to push rudder rod to thread in the adjuster located in the rudder horn. Make sure the rudder centered and then Retighten the two adjuster with 2.5mm Allen Key.

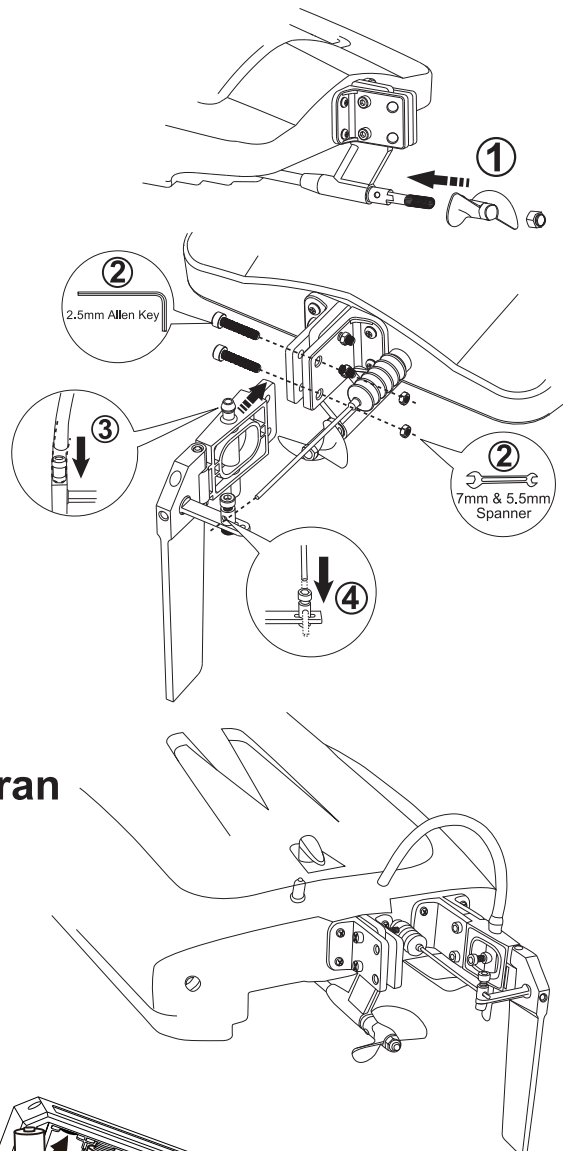

Rudder Assembly For US.1 Catamaran

NOTE: Please install rudder and support on the right support which is pre-installed on the rear of hull in factory. Installing rudder and support on the right side is effective for good performance and stability.

Installing the transmitter

NOTE: The transmitter is not water resistant and should never come in contact with water.

1. Install four fresh “AA” batteries. Follow the diagram located in the bottom of the battery tray for prope battery orientation.
2. Turn the transmitter “ON” The battery light should glow bright RED.

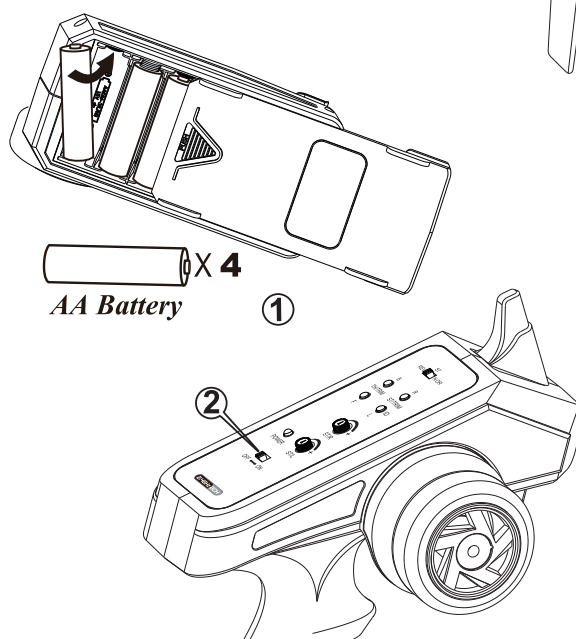

Receiver connection diagram

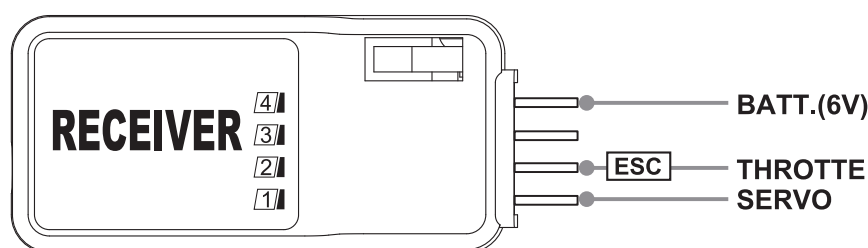

Note: If ESC with BEC function, no need to connect battery with receiver.

Caution: Before racing boat,
Please use ballon supplied
in tool bag to wrap receiver
for water proof

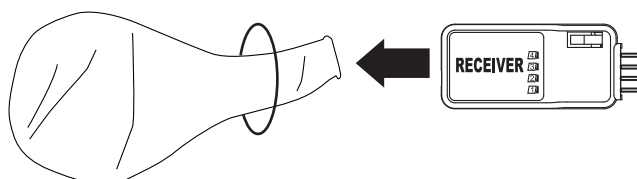

Installing the Battery

NOTE: We recommend you 1 pack of 11.1V 2200mAh 35C Lipo battery for maximum performance.

Using the Provided Hook and Loop which are already tied on the battery locators inside the hull to tie the battery. The battery locators help align the batteries for the best running center of gravity for maximum performance. Below are the batteries location inside the hull.

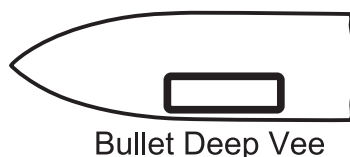

Bullet Deep Vee

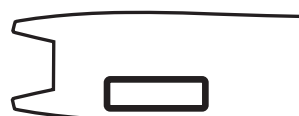

US-1 Catamaran

NOTE: 1. There is a water proof rubber ring placed along the slot of hull, always make sure it's secured positioned before re-position the upper deck.

TRANSMITTER/RECEIVER BINDING

The binding process effectively ties the transmitter and receiver together. Under normal circumstances, both items are supplied like this from the factory. If, however, you find that your transmitter and receiver are not bound(receiver's red LED is on), you should do the following:

- 1) Switch "ON" the transmitter.
- 2) Switch "ON" the receiver by connecting battery to ESC, and ESC cord is plug into Receiver properly(Note:ESC has BEC function).
- 3) Press down the "BIND" button on the receiver, the receiver's green LED will be on to indicate that binding has been successful and the receiver will now accept commands from the transmitter.

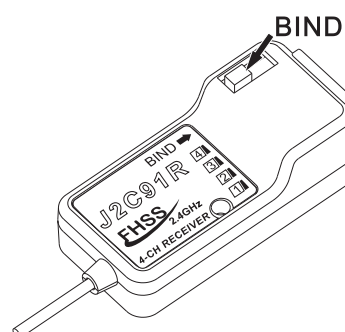

Note 1: During binding process, transmitter and receiver should be no more than one meter apart and no other similar devices should be within 10 meters.

Note 2: if the green light flashing, showing the binding failure, please do again as above indication.

Checking the radio system

1. Always turn the power "ON" to the transmitter before connecting the batteries with the ESC.
2. Plug the battery into the ESC plugs and listen for three continuous >Be<>Be<>Be< . (Signal noise of auto detected ESC)
3. Pull the throttle & motor rotate in anticlockwise direction, your motor is now armed and ready for operation.
4. Check the direction of the rudder, the trailing edge of the rudder should turn right when right input is given. Conversely, when left input is given, the trailing edge of the rudder should turn left.

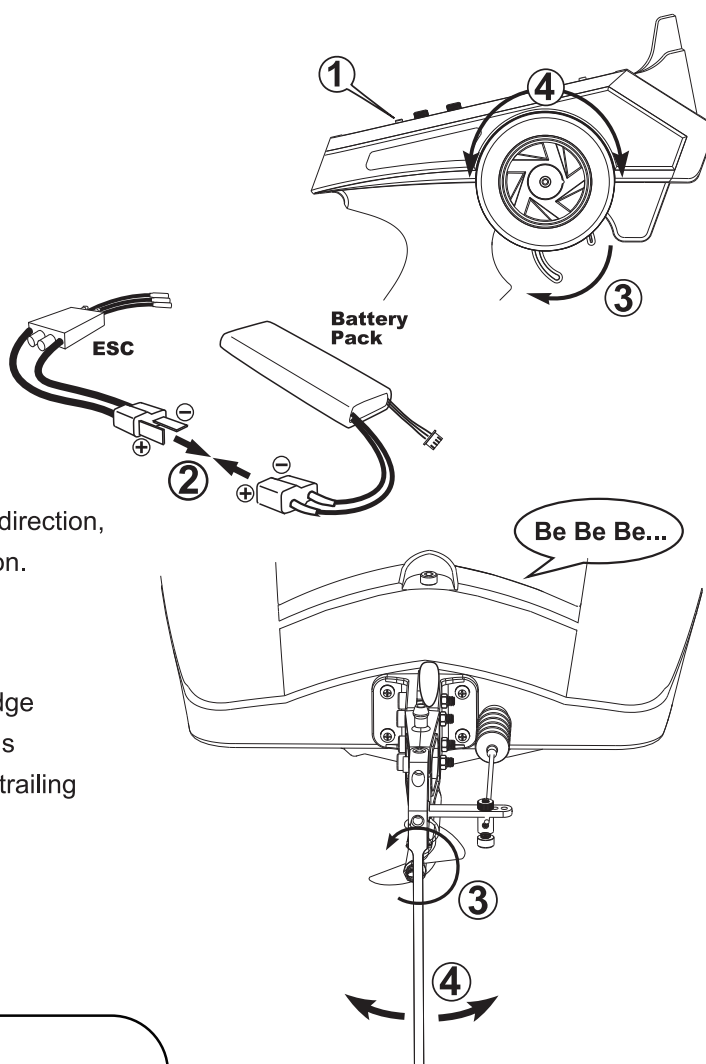

Transmitter introduction

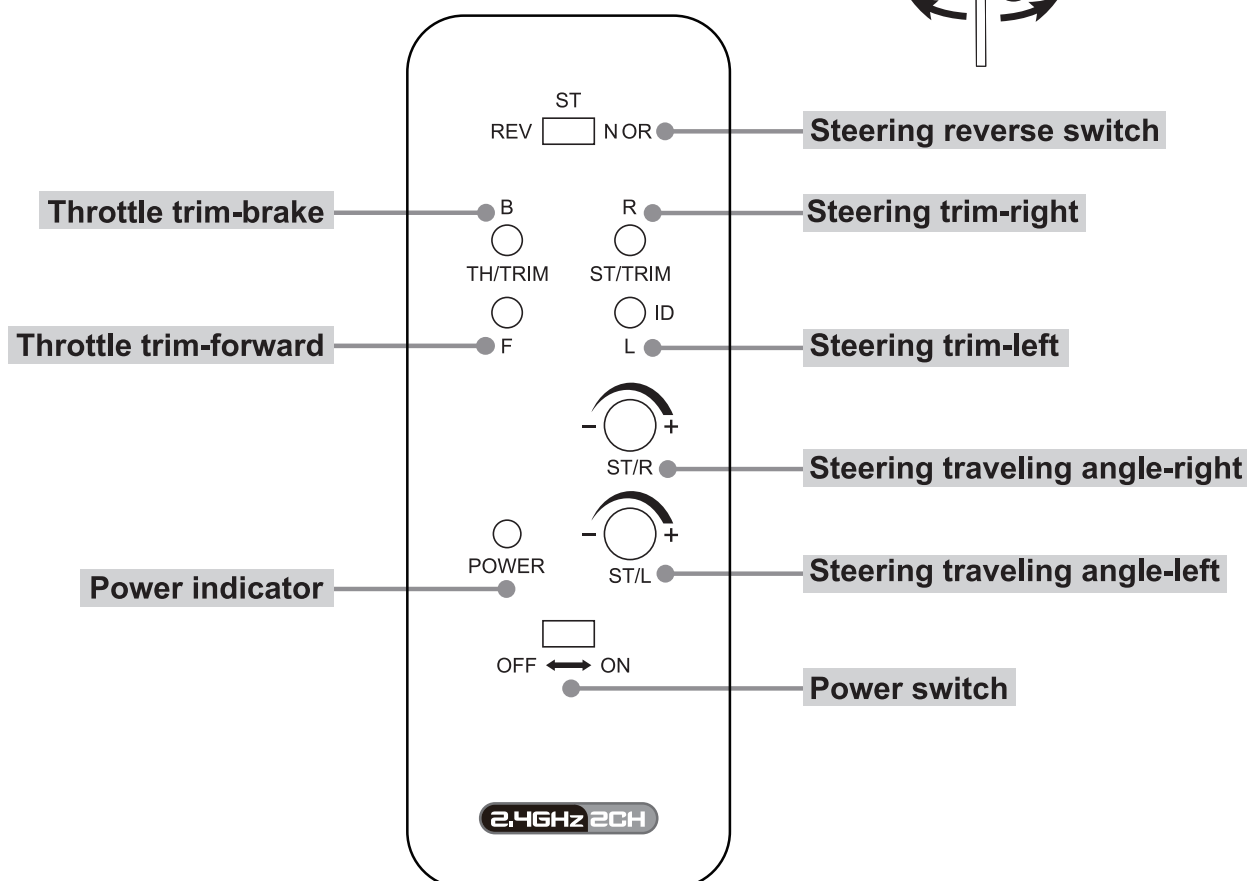

EPA Adjustment

Function

Use this when performing left and right steering angle adjustments. End Point Adjustment (EPA) adjusting value range: 0%-100%

Setting

1. Steering (right side) angle adjustment Rotate "ST/R" knob to the left end point means minimum value 0%, right end point means maximum value 100%.
2. Steering (left side) angle adjustment Rotate "ST/L" knob to the left end point means minimum value 0%, right end point means maximum value 100%.

CAUTION:

When adjusting this function, make sure the direction is in agreement with the boat direction, you can adjust by the STEERING "REV-NOR" button.

Steering reverse switch

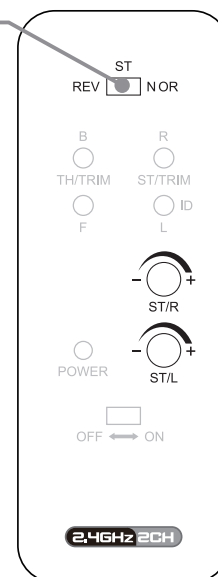
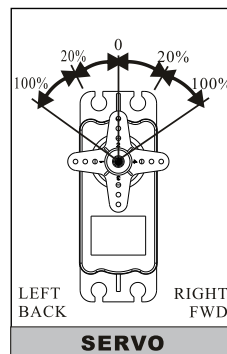

Trim Adjustment

Steering trim

Adjust "ST/TRIM" "R/L" so that rudder is centered prior to operation, you may adjust this control to make the boat run straight during operation.

CAUTION:

When adjusting steering trim, make sure the direction is in agreement with the boat direction, you can adjust by the STEERING "REV-NOR" button.

Steering reverse switch

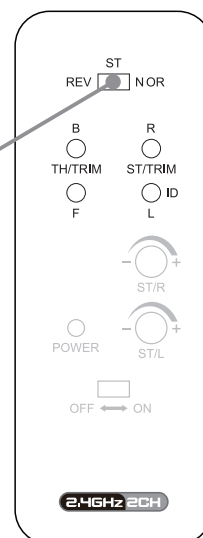

Throttle trim

Adjust "TH/TRIM" "B/F" to stop propeller from turning while the throttle trigger is in the neutral position.

Speed Control Specification

The Joysway brushless motor boat is assembled with 60A water cooled brushless ESC, please see belowing the specification:

protections: Thermo protection activated at 120°C. LVP(low voltage protection) engaged when Lipo battery (per cell) drop down to 3.2 Voltage.

Operating Cells: 2S - 4S Lipo

Current Rating: 60A

Peak Current: 70A within 10 seconds.

BEC Output: 2A / 5V

Calibration: 1. Ser the trigger to maximum throttle then turn on the transmitter.

2. Connect motor and receiver to the ESC.

4. After 4 high pitched tones, set the trigger to minimum throttle.

5. After 3 repeat monotones, cut off the power of ESC.

Lubricating The Drive Shaft

Lubricating the flexshaft is vital to the life of the drivetrain. The lubricant also acts as a water seal, keeping water from entering the hull through the stuffing box.

Lubricate the flexshaft, propeller shaft and all moving parts after every 2–3 hours of operation.

1. Use the 2mm Allen key to loose the two grub screws of the coupler which connects the flexshaft, then slide the flexshaft w/ prop shaft out of the stuffing tube.

2. Lubricate the flexshaft w/ prop shaft with the water proof marine grease, reinstall the flexshaft w/ prop shaft in reverse order, be sure to retighten the two grub screws of coupler.

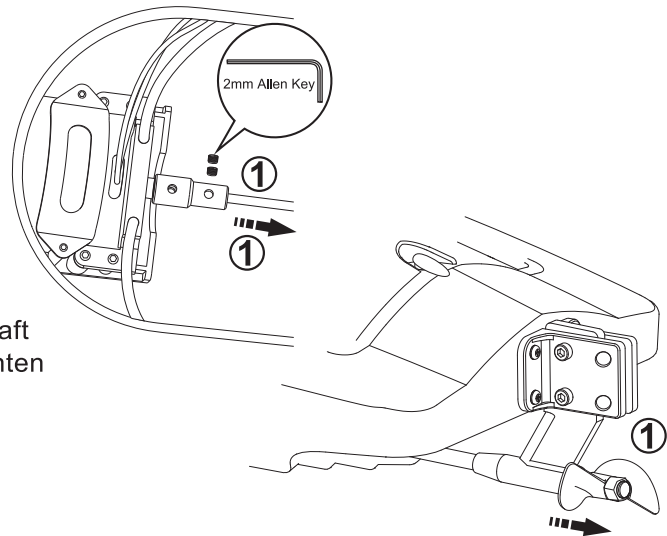

NOTE: Running the model boat in salt water could cause some parts to corrode. If you run the boat in salt water, rinse it thoroughly in fresh water after each use and lubricate the drive system.

Spare part list

To order Joysway brushless motor boat spare parts, use the part numbers in the spare parts list that follows.

PART NO.	DESCRIPTION
83001	Bullet Deck
83002	water proof rubber ring (PK2) for Bullet
83003	US.1 Deck
83004	water proof rubber ring (PK2) for US.1
83005	BL2815 Out-runner brushless motor
83006	Coupler for BL2815
83007	water cooling jacket for BL2815 motor
83008	Flex shaft set for bullet
83009	Flex shaft set for US.1
83010	rear shaft strut support set
83011	Connected rod of Rudder for Bullet
83012	Connected rod of Rudder for US.1
83013	Aluminum alloy rudder
83014	37g standard servo
83016	Rudder clevis (PK2)
830102	60A Water Cooled Brushless ESC w/ one Deans Connector
92008	P1.4X40mm Two Blade Nylon Propeller
93017	water-proof rudder pushing rod tube(PK2)



FCC WARNING: Changes or modifications not expressly approved by the party responsible for compliance could avoid the user's authority to operate the equipment.