

# INSTRUCTION MANUAL

**THIS MODEL IS NOT A TOY!**

THESE INSTRUCTIONS SHOULD BE READ BY A SUPERVISING ADULT

## MAD SHARK 2.4GHz RTR BRUSHLESS Mini F1 SPEED BOAT

ITEM NO.8205

### CONTENTS OF SET

- |                                     |  |
|-------------------------------------|--|
| 1) Mad Shark Racing Boat            | 5) Boat Stand                            |
| 2) Transmitter                      | 6) 9V Dry battery (for Transmitter)      |
| 3) Spare Nylon Propeller            | 7) 2.5mm Allen Key (For pushrod tighten) |
| 4) Deans Plug W/Heat Shrinking Tube | 2.0mm Allen Key (for Grub Screws)        |

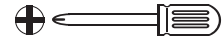
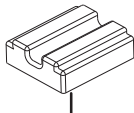
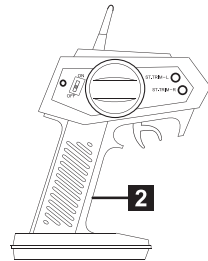
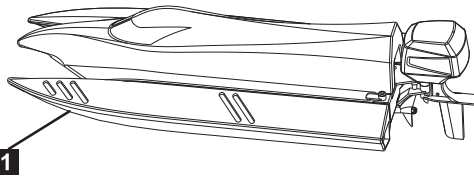

CROSS-HEAD SCREWDRIVER - 1PC  
(NOT INCLUDED)

### ATTENTION:

Before racing your model boat, carefully check silicone tube for guarantee good water cooling system; Avoid water inlet on the bottom of hull become deformed, otherwise, water cooling system failure, this may lead to ESC burned out and motor defected.

### IMPORTANT

Mad Shark is designed for use in fresh water only. It is not designed for use in salt water!

Mad Shark is not intended for persons under 14 years of age, unless closely supervised by an adult.

This model is capable of over 45 KPH, Personal injury or property damage may result from misuse of this product, take care and enjoy your model responsibly.

## BATTERY RECOMMENDATION

One pack of 11.1V 1200mAh 25C Lipo battery (Not included)

**NOTE:** If you have existing 11.1V Lipo battery pack, you can update them for use by changing the connector to Deans connector which is included in the kits bag, be sure to solder the connector to the battery in the proper polarity. (1 Male Deans connector is already soldered with the ESC, the other 1 Female Deans connector is included in the kits bag)

## CHARGER RECOMMENDATION

2S/3S Balance Charger and adapter, or multi-functional intelligent charger (Not included)

## INSTALLING THE 9V DRY BATTERY IN YOUR TRANSMITTER

**Always use a fresh 9V battery in the transmitter.**

- 1) Ensure transmitter 'ON/OFF' switch is in the 'OFF' position.
- 2) Remove battery cover screw.
- 3) Remove battery cover by pressing down on the embossed arrow and sliding the cover as indicated.
- 4) Insert 9V battery, noting correct location (polarity + or -).
- 5) Slide battery cover back into place.
- 6) Re-fit battery cover screw.

**NOTE 1:** Mad Shark is supplied with a start-up 9V dry cell battery. Once this battery is depleted, please replace it with another dry cell 9V battery (alkaline recommended) or fully charged 9V rechargeable battery. Remove 9V battery from the transmitter if you do not intend to use it for a period of time.

**NOTE 2:** When the transmitter battery (dry cell or rechargeable) is at the end of its life, it should be disposed of at an approved battery recycling centre. **DO NOT DISPOSE OF IT IN HOUSEHOLD WASTE!**

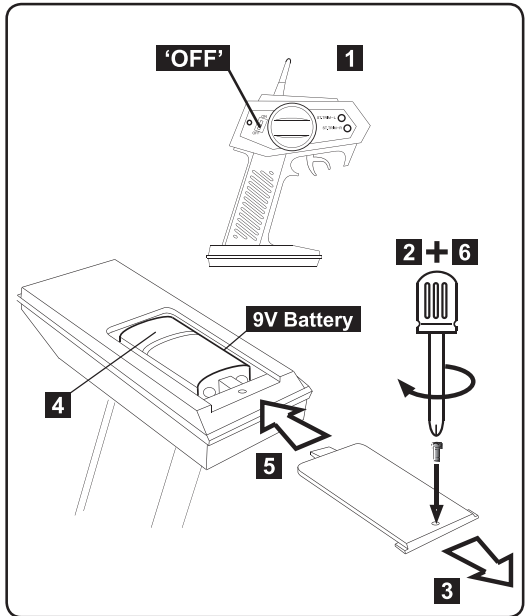

## INSTALLING THE 11.1V LIPO IN THE MAD SHARK

1. Switch on transmitter power, the light glows bright red.
2. firstly rotate the plastic lock underneath the boat head, then rotate the two plastic lock at the rear of hatch to remove the hatch.

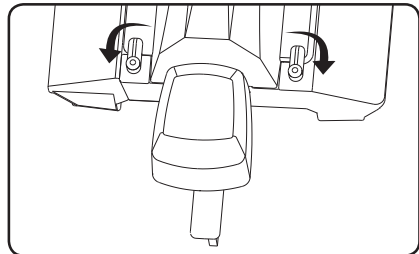
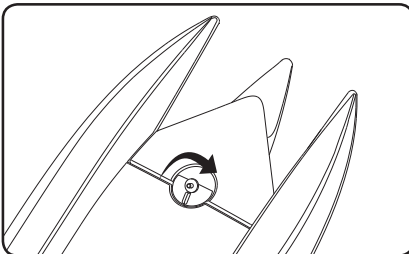

3. Place the boat hull on the polyfoam boat stand
4. Fixt the charged finished battery inside the hull with velco strap.
5. Attach battery connector to the matching connector of ESC.
6. Receiver's light glow green, ESC will make sound of "Do, Do, Do".
7. Re-position hatch by rotating plastic lock at the end of hatch firstly, then rotate the plastic lock underneath the boat head.

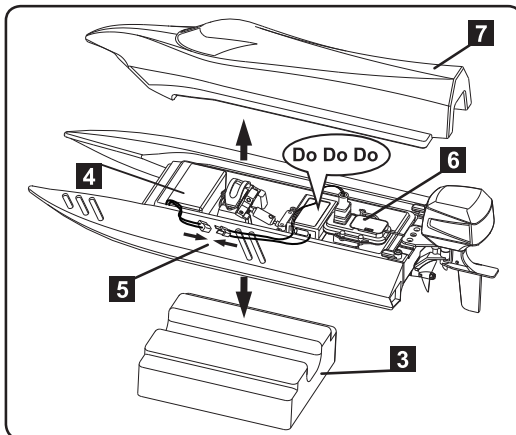

- NOTE:** 1. There is a water proof rubber ring placed inside gift box, always make sure it's secured positioned before re-position the hatch.
2. It is suggested that don't leave the rubber ring in the slot of hull. Remove the rubber ring when not racing the boat, so as to keep the rubber ring flexible for water proof effective.

## TRANSMITTER/RECEIVER BINDING

The binding process effectively ties the transmitter and receiver together. Under normal circumstances, both items are supplied like this from the factory. If, however, you find that your transmitter and receiver are not bound(receiver's red LED is on), you should do the following:

- 1) Switch "ON" the transmitter.
- 2) Switch "ON" the receiver by Attaching the 11.1V LiPo's connector to the matching connector in the Mad Shark.
- 3) Press down the "BIND" button on the receiver, the receiver's green LED will be on to indicate that binding has been successful and the receiver will now accept commands from the transmitter.

**Note 1:** During binding process, transmitter and receiver should be no more than one meter apart and no other similar devices should be within 10 meters.

**Note 2:** if the green light flashing, showing the binding failure, please do again as above indication.

## HOWTO CONTROL/OPERATE YOUR MAD SHARK

### 1) Forward Throttle Trigger

Your Mad Shark can be driven forward by pulling the throttle trigger. Release the trigger and the Mad Shark will stop.

### 2) Left/Right Steering Wheel

The steering wheel controls Mad Shark's left and right movement. Turn the wheel to the left to steer to the left. Turn the wheel to the right to steer to the right. Release the wheel to go straight.

Racing Tip: Mad Shark is an oval racer, designed for clockwise racing, and will be less responsive to steering inputs at high speed, Decrease your speed to allow tighter turning.

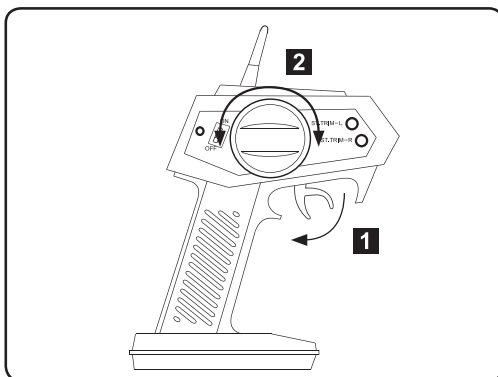

## SELF-RIGHTING FEATURE

Intelligent hull design with self-righting feature, separated left part of hull laser cutted with holes. When boat accidentally turn over in high speed racing in big wave, don't worry, please wait for a while, the water will come into left part of hull through holes, changing the CG of boat, then it will automatically self-righting and keep racing, water will be drained out from the hole of rear hull.

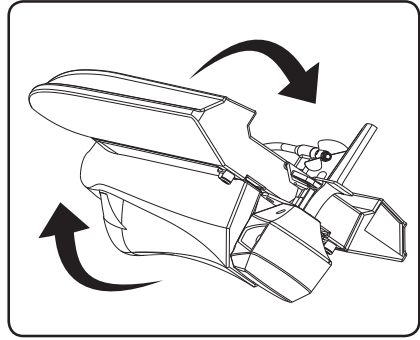
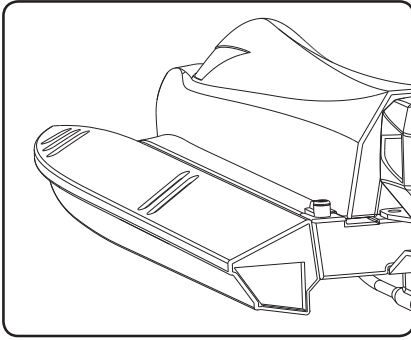

### AFTER USE

- 1) When you have finished using your Mad Shark, you should first switch 'OFF' the model (disconnect the 11.1V LiPo), then switch 'OFF' your transmitter.
- 2) Remove all batteries from the transmitter and model.
- 3) Leave Mad Shark 's upper deck off to allow moisture to evaporate. Ideally, place the model in this way in a warm and dry place, like an airing cupboard, until you are sure it is dry and then store it away.
- 4) Remove the rubber ring from the slot of hull, so as to keep the rubber ring flexible for water proof effective in next time boat racing.

**NOTE:** If Mad Shark begins to bob when running, it may have taken on an excessive amount of water. In this case, you should immediately return to shore, remove the upper deck and drain the water from the hull.

## IF THE MAD SHARK DOES NOT RUN IN A STRAIGHT LINE

If your Mad Shark does not run in a straight line when not being steered, you can adjust it by using the steering trim located on the upright hand side of the transmitter.

- 1) Run your Mad Shark on calm water when adjusting the steering. If your model runs to the right when not being steered, press the "ST.TRIM-L" button. Re-center the model and see if this has corrected the problem. Keep making small adjustments in this way until the model runs straight.

Press the "ST.TRIM-R" button to correct if your model steers to the left without being steered in the same way as detailed above.

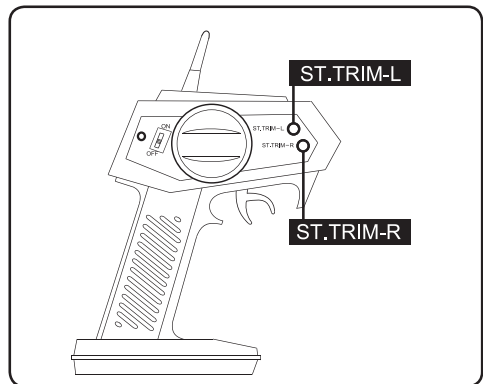

## LUBRICATING DRIVE SHAFT

Lubricating the flexshaft is vital to the life of the drivetrain. The lubricant also acts as a water seal, keeping water from entering the hull through the stuffing tube. Lubricating the flexshaft, propeller shaft after every 2 or 3 times of operation.

1. Use the 2mm Allen key to loose the two grub screws of the coupler which connects the flexshaft, then slide the flexshaft w/ prop shaft out of the stuffing tube.
2. Lubricate the flexshaft w/ prop shaft with the water proof marine grease, reinstall the flexshaft w/ prop shaft in reverse order, be sure to retighten the two grub screws of coupler.

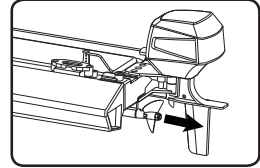
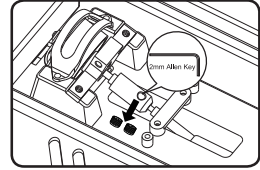

## IMPORTANT - Mad Shark

**The bearing in the water cooled motor mount must be regularly lubricated with oil, grease or Vaseline petroleum jelly to prevent corrosion through the ingress of water.**

**Insufficient lubrication may lead to the premature failure of the bearing.**

**Note: Image shows drive shaft removed for clarity - the bearing can be lubricated with the drive shaft in situ.**

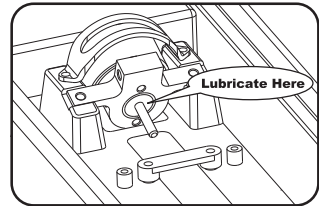

## CAUTION!

**Please observe the following warnings. DURING OPERATION**

- The transmitter's range will vary depending on your surroundings and battery strength. Do not operate Mad Shark too far away or control will be lost.
- Ensure that all batteries are correctly installed and that the 11.1V LiPo is fully charged.
- Do not operate your Mad Shark in areas with strong currents, in salt water or areas of water with large waves.
- Do not touch moving parts during operation, especially the propeller.
- Do not let your Mad Shark run aground, as this can cause damage.
- If you lose control of your Mad Shark, never wade into deep water or water with strong currents to retrieve it. First, hold the transmitter as high as you can to try to re-establish control. If this does not work, find another way to move closer to the model, but do not endanger yourself in the process!

## GENERAL INFORMATION FOR THE SAFE OPERATION OF YOUR MAD SHARK

**Please follow these simple rules to ensure safe operation and gain the maximum enjoyment from your model.**

- Avoid overloading your model. Never run it in areas where its movement will be restricted, e.g. areas where there is pond weed, etc., as this can over stress the motor.
- Ensure nothing prevents the smooth running of moving parts.
- Do not run your model in confined spaces.
- Never run your model in a public space where it might upset or endanger people or wildlife.
- Immediately switch 'OFF' your model and transmitter if you see lightning or hear thunder. Never use your model in the rain.

Do not dismantle or tamper in any way with this R/C vehicle and its transmitter. The manufacturer and distributor will accept no responsibility, expressed or implied, for accidents or injuries caused as a result of disassembly, modification and/or usage against the Instructions for this product. Tampering or modification will also invalidate the guarantee.

## TROUBLE SHOOTING

Check using the chart below before returning your Mad Shark for repair as many problems can be easily solved

PROBLEM	CAUSE	REMEDY
Model will not move	No battery in transmitter/model Battery installation is incorrect Weak battery in transmitter Weak batteries in model	Install batteries Install batteries correctly Install a fresh battery Recharge 11.1V LiPo
No control of model	Weak battery in transmitter	Install a fresh battery
Limited radio range	Weak battery in transmitter	Install a fresh battery

## SPARE PARTS

<b>PART NO.</b>	<b>DESCRIPTION</b>
820501	Mad shark brushless motor
820502	motor mount set
820503	Mad shark Deck(white) & water proof gasket
820504	Flex Shaft set for Mad shark
820505	Scale Outboard engine and rudder set
820507	11.1V 1200mAH LiPO Pack
820508	3S balance charger and DC adapter
820509	2.4GHz Transmitter for Mad shark brushless
820510	two bearing inside rear shaft strut
820511	P1.4X35mm diameter 3.1mm Two Blade Nylon Propeller (PK2)
82034	Coupler for CF2812 motor
82035	20A Water Cooling Brushless ESC w/ BEC
82041	2.4GHz Receiver-J4C11RB
82058	deck plastic lock set



FCC WARNING: Changes or modifications not expressly approved by the party responsible for compliance could avoid the user's authority to operate the equipment.